

Product Code
706623

Rev.Nr.
11.05.2021



DP3000

AUS

Dumper

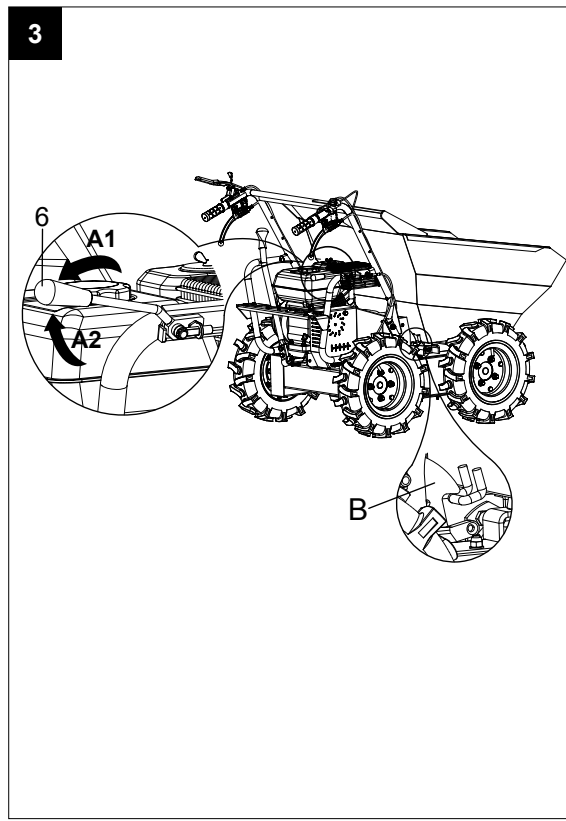
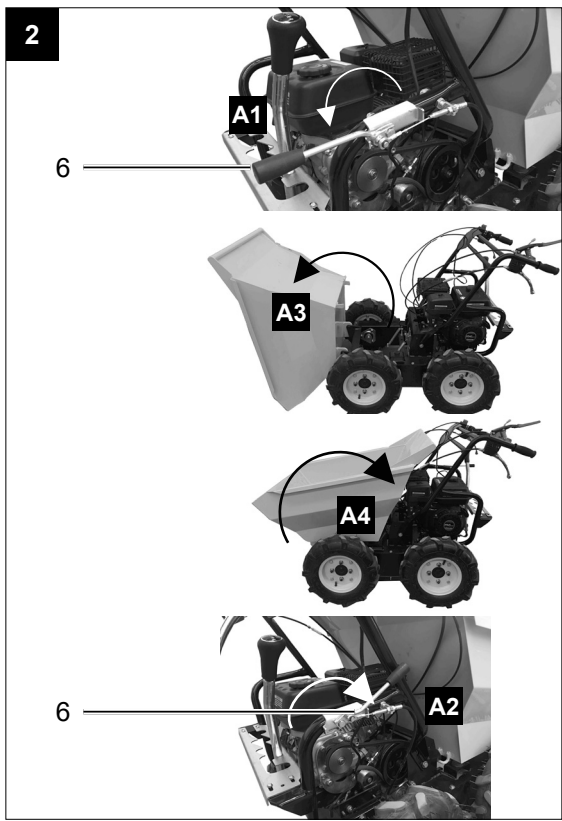
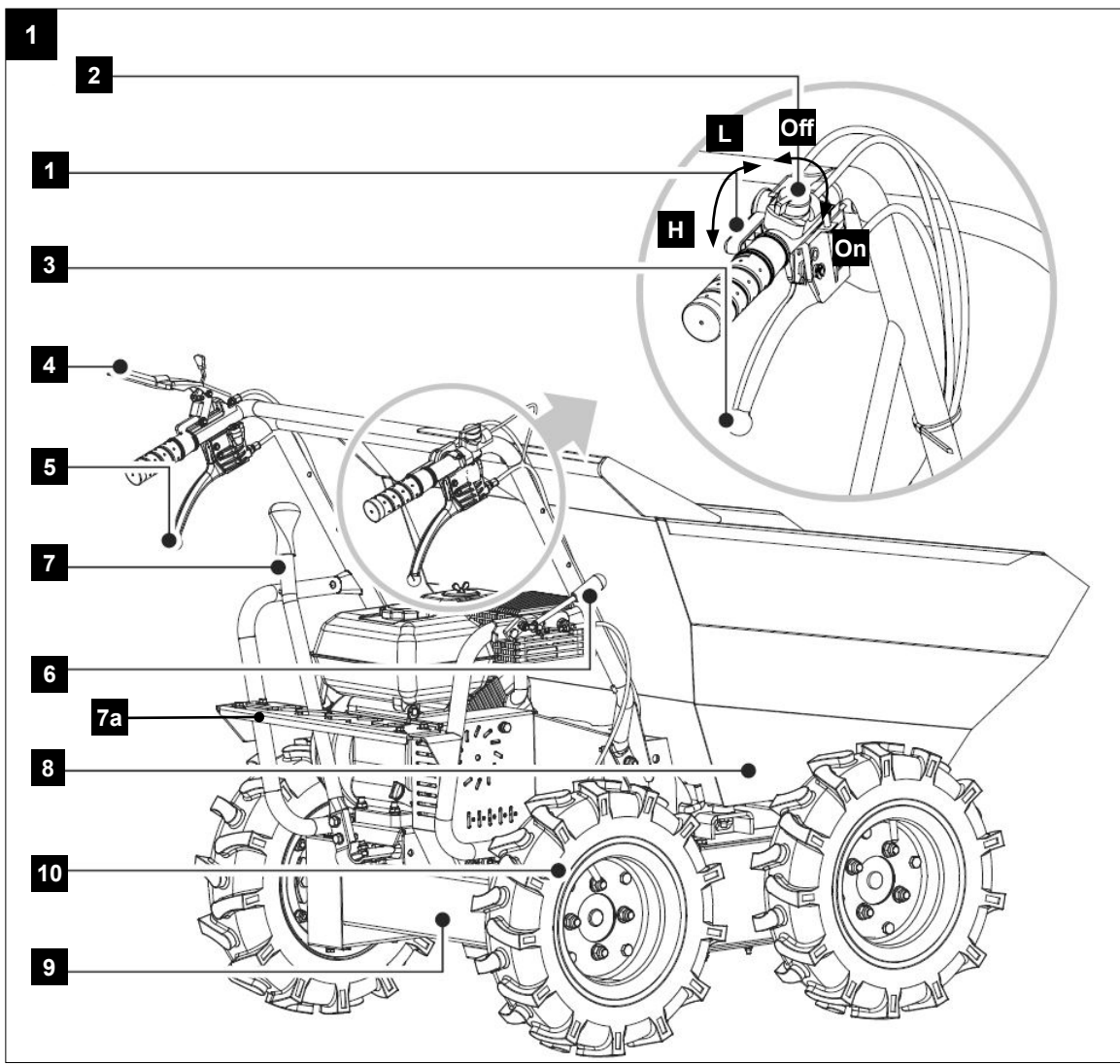

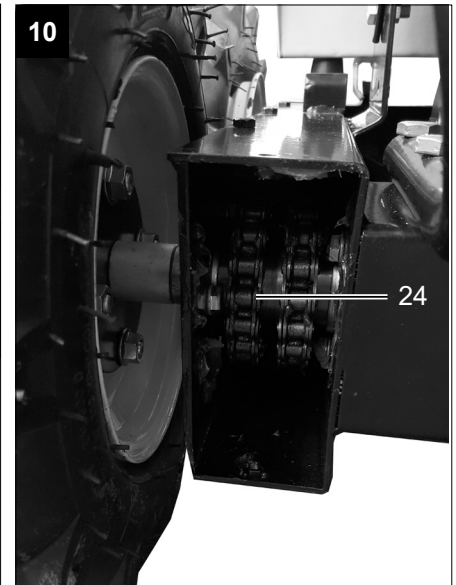
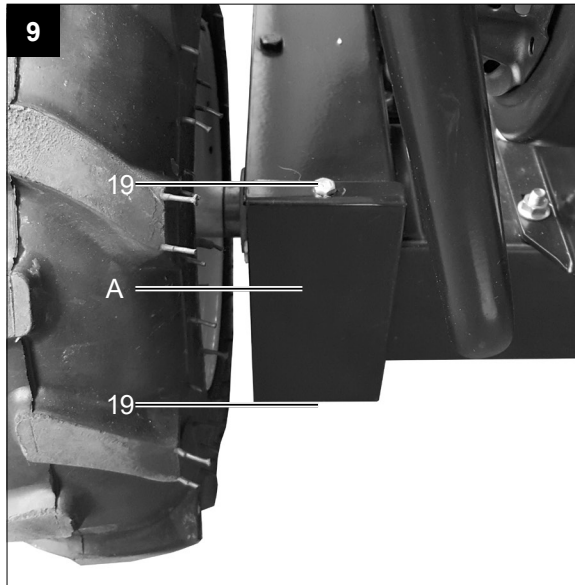
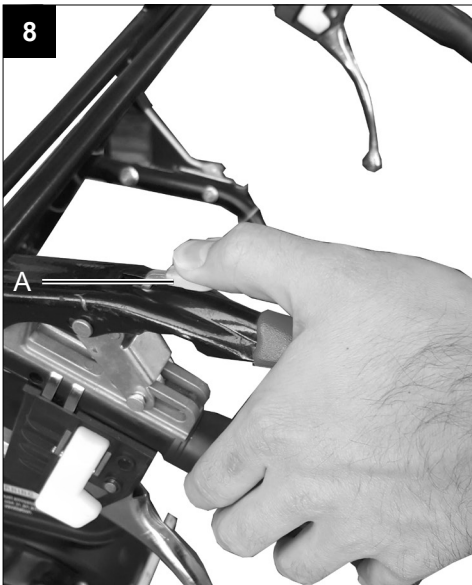
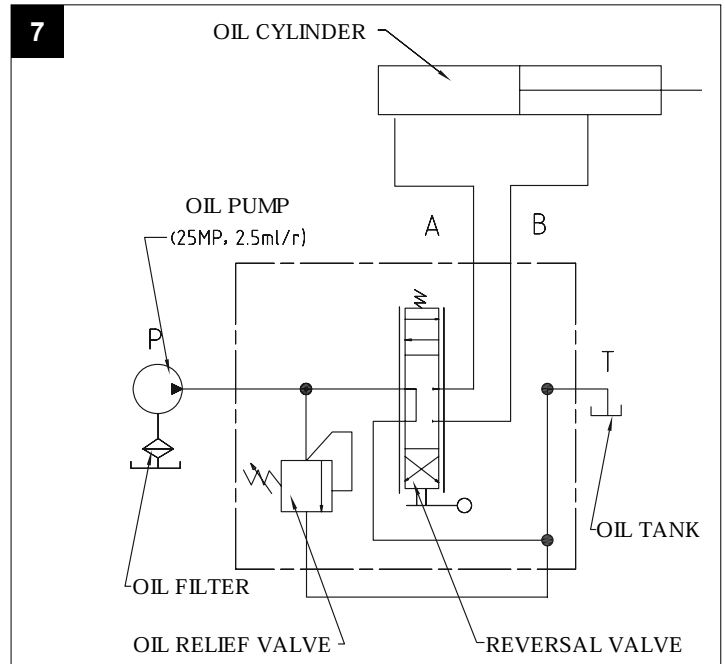
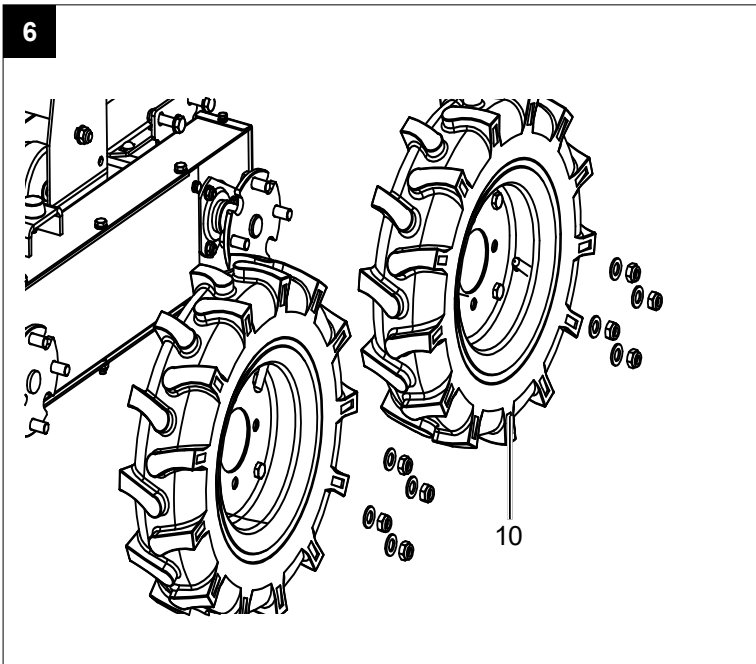
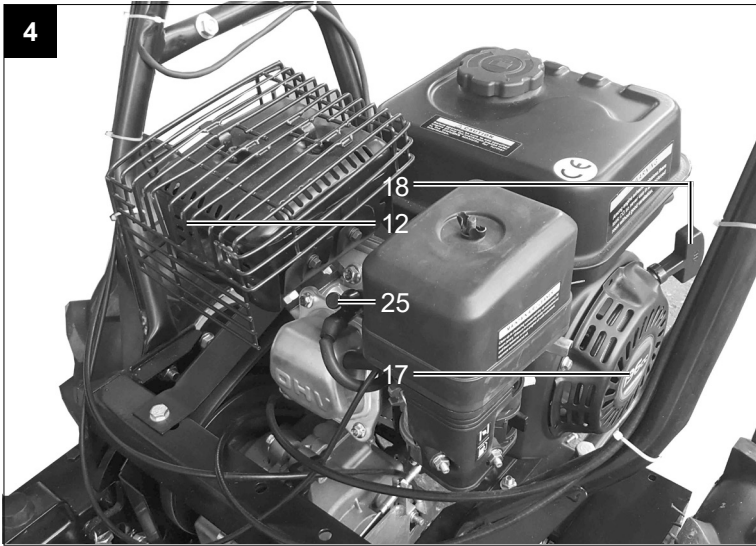

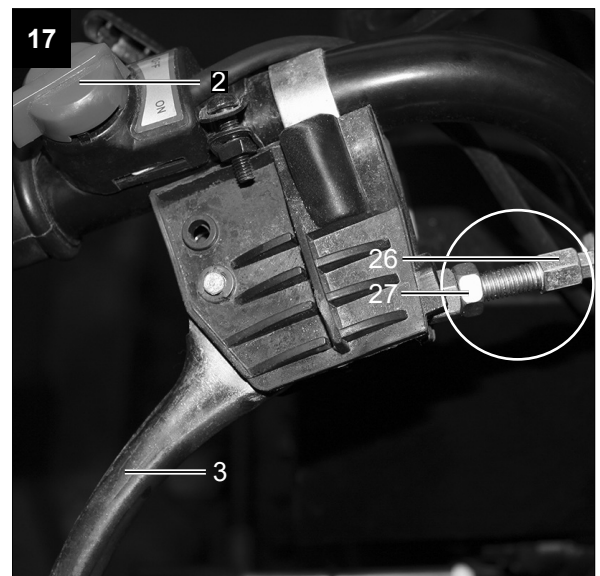
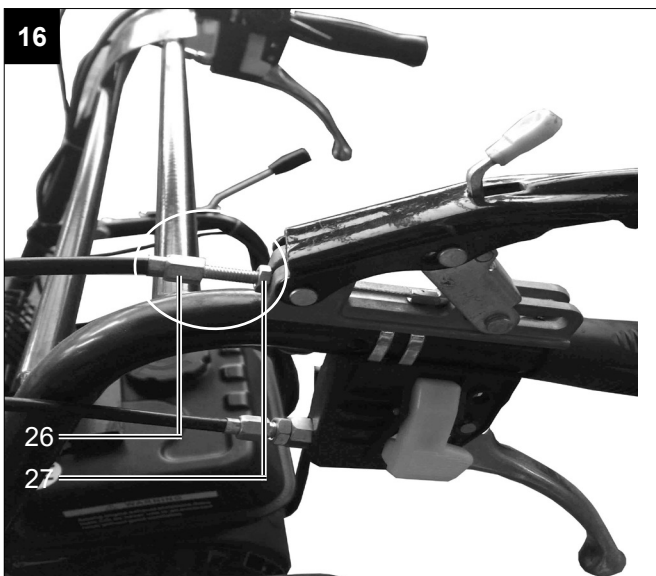
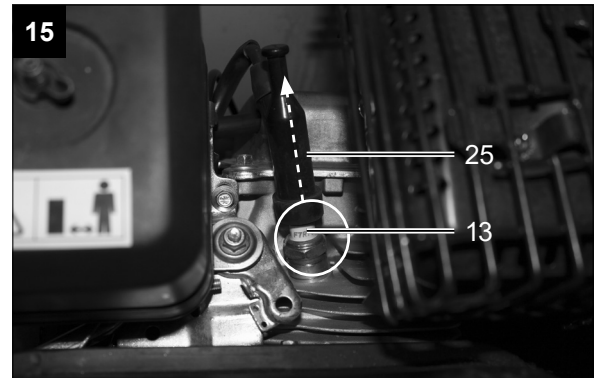
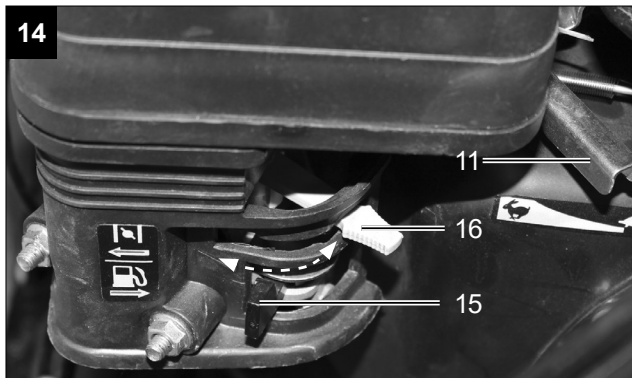
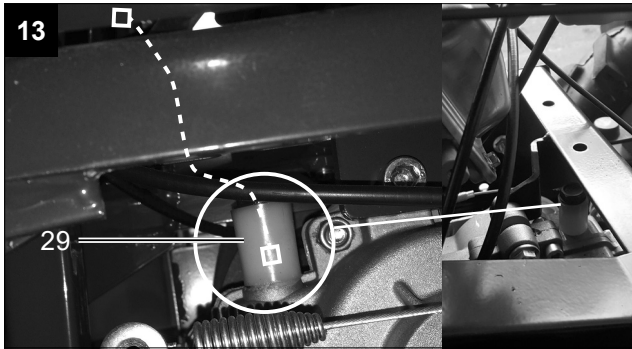
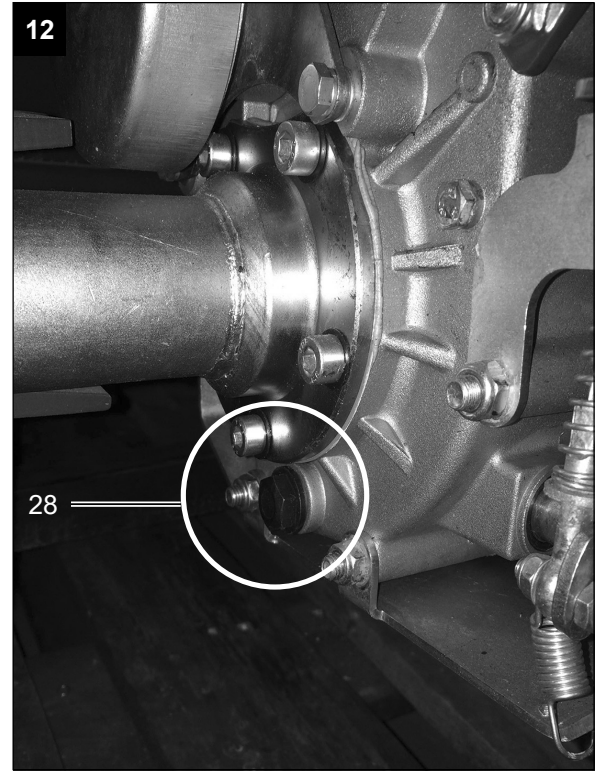
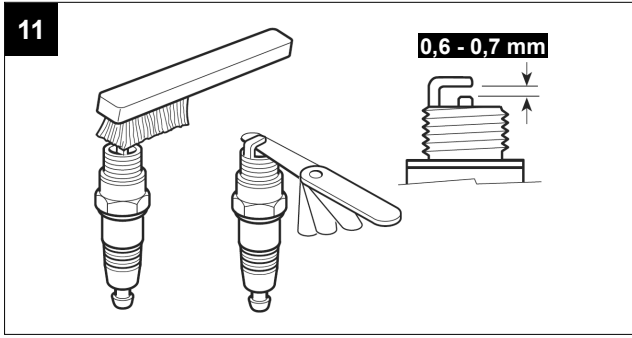

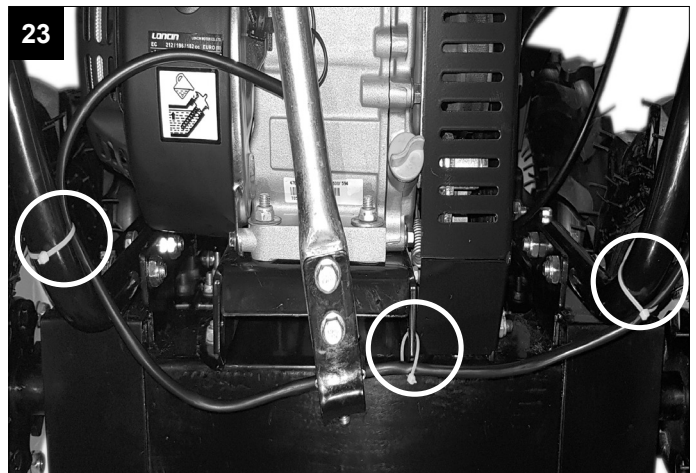
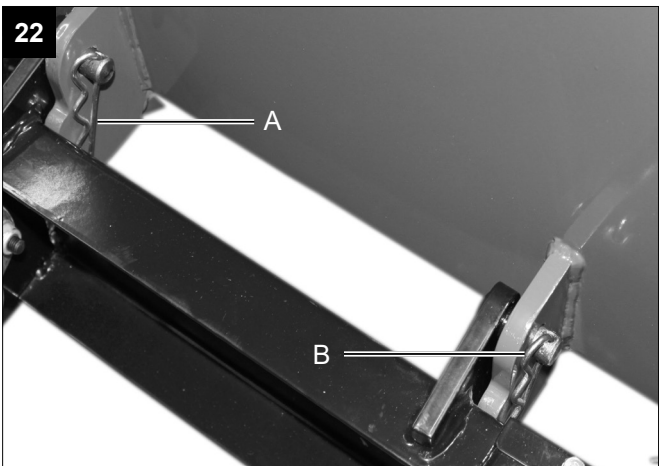
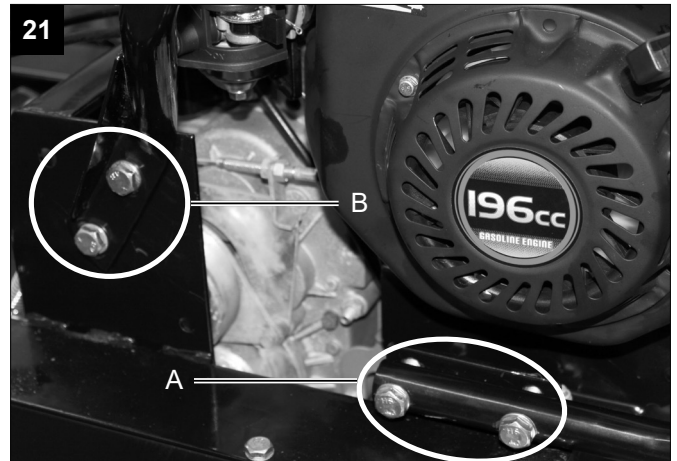
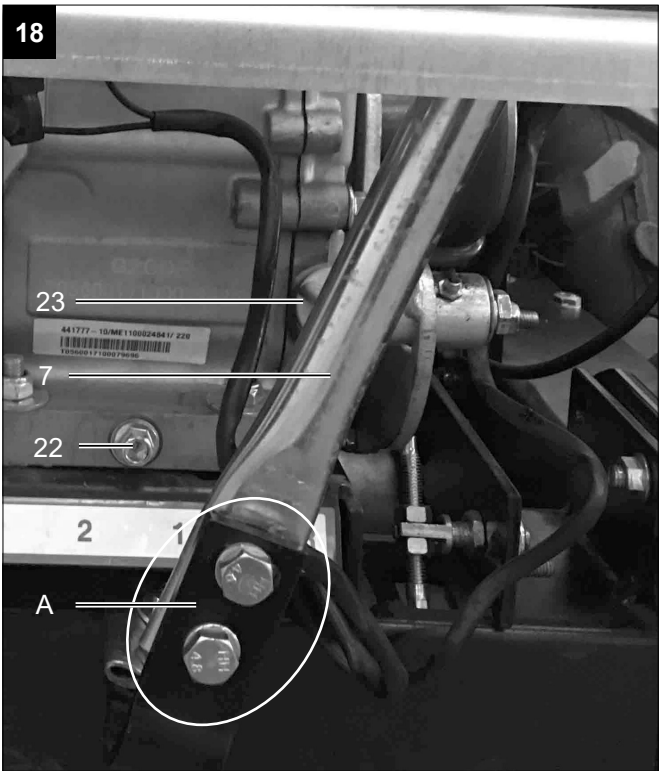

Explanation of the symbols on the machine

The use of symbols in this manual is intended to draw your attention to possible risks. The safety symbols and the explanations that accompany them must be perfectly understood. The warnings in themselves do not remove the risks and cannot replace correct actions for preventing accidents.

	<p>Read these instructions carefully.</p>
	<p>Wear hearing protection.</p>
	<p>Wear eye protection.</p>
	<p>Wear safety shoes.</p>
	<p>Wear safety gloves.</p>
	<p>It is forbidden to remove or to manipulate guards and safety devices.</p>
	<p>Do not touch hot machine components.</p>
	<p>Do not smoke or have open flames.</p>
	<p>Flinging objects can cause injury.</p>
	<p>Keep bystanders away.</p>





 	<p>Do not use the machine on slopes with slopes greater than 20 °. Danger of tipping!</p>
 	<p>Poisoning! Only use the machine outdoors and never in closed or poorly ventilated rooms.</p>
	<p>Secure the machine against unintentional switching on before carrying out maintenance and / or repair work.</p>
<p>⚠ Attention!</p>	<p>In this operating manual, we have used this sign to mark all sections that concern your safety.</p>

Table of contents:

Page:

1.	Introduction.....	9
2.	Machine description	9
3.	Scope of delivery.....	9
4.	Proper use.....	10
5.	Safety information	10
6.	Technical data	13
7.	Unpacking	14
8.	Before starting the machine	15
9.	Functions and controls	15
10.	Cleaning	16
11.	Transport	16
12.	Storage	17
13.	Maintenance.....	17
14.	Disposal and recycling	18
15.	Troubleshooting.....	19

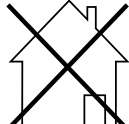
1. Introduction

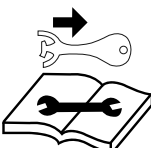
Dear customer,

We hope your new tool brings you much enjoyment and success.

Note:

In accordance with the applicable product liability laws, the manufacturer of this machine assumes no liability for damage to the machine or caused by the machine arising from:

- Improper handling,
- Non-compliance with the operating manual,
- Repairs carried out by third parties, unauthorised specialists.
- Installing and replacing non-original spare parts,
- Application other than specified,

Please consider:

Read through the complete text in the operating manual before installing and commissioning the machine.

This operating manual should help you familiarise yourself with your power tool and teach you how to use it for its intended purpose.

The operating manual include important instructions for the safe, proper and economic operation of the power tool, for avoiding danger, for minimising repair costs and downtimes and for increasing the reliability and extending the service life of the power tool.

In addition to the safety instructions in this operating manual, you must also observe the regulations applicable to the operation of the power tool in your country.

Keep the operating manual package with the power tool at all times and store it in a plastic cover to protect it from dirt and moisture. They must be read and carefully observed by all operating personnel before starting the work. The power tool may only be used by personnel who have been trained to use it and who have been instructed with respect to the associated hazards.

In addition to the safety instructions in this operating manual and the separate regulations of your country, the generally recognised technical rules relating to the operation of such machines must also be observed.

We accept no liability for accidents or damage that occur due to a failure to observe this manual and the safety instructions.

2. Machine description (Fig. 1-20)

1. Throttle Control
2. Engine Switch
3. Right Steering Lever
4. Clutch Control Lever
5. Left Steering Lever
6. Fixation dump box
7. Gear Selection Lever
- 7a Gearshift panel
8. Dump Box
9. Gearbox
10. Wheel

Engine components

11. Throttle
12. Exhaust
13. Spark plug
14. Air filter
15. Petrol valve
16. Choke lever
17. Recoil starter
18. Handle Recoil starter
19. Mounting screw service port
20. Fuel cap
21. Fuel tank
22. Oil drain plug engine oil
23. Oil filler opening / oil dipstick
24. Drive chain
25. Spark plug connector
26. Adjusting device
27. Counter nut
28. Oil drain plug gear unit
29. Oil filler gear oil unit

3. Scope of delivery

- Dumper DP3000
- Steering rod
- Transport tray
- Wheels
- Shift lever
- Plastic bag with mounting material
- Instruction manual,
- Engine manual

4. Proper use

The machine is to be used only for its prescribed purpose. Any other use is deemed to be a case of misuse. The user / operator and not the manufacturer will be liable for any damage or injuries of any kind caused as a result of this.

To use the machine properly you must also observe the safety information, the assembly instructions and the operating instructions to be found in this manual. All persons who use and service the machine have to be acquainted with this manual and must be informed about the machine's potential hazards.

It is also imperative to observe the accident prevention regulations in force in your area. The same applies for the general rules of health and safety at work.

The manufacturer will not be liable for any changes made to the machine nor for any damage resulting from such changes.

The machine is to be used only for its prescribed purpose. Any other use is deemed to be a case of misuse. The user / operator and not the manufacturer will be liable for any damage or injuries of any kind caused as a result of this. Please note that our machine has not been designed for use in commercial, trade or industrial applications. Our warranty will be voided if the machine is used in commercial, trade or industrial businesses or for equivalent purposes.

5. Safety information

These operating instructions provide places concerning your safety which are marked with this indication:



Furthermore this manual contains other important sections which are marked with the word "Attention!".

Attention!

While using the machine some safety precautions must be observed to prevent injuries and damage. Read the directions with due care. If you give the machine to any other person, give them these operating instructions as well. We assume no liability for injuries or damages which are a results of non-compliance of this manual and its safety notes.

DANGER

Failure to follow these instructions may cause serious danger to life of danger or fatal injuries.

WARNING

Failure to follow these instructions may cause danger to life or danger of serious injuries.

CAUTION

Failure to follow these instructions may cause light to medium risk of injury.

NOTE

Failure to follow these instructions may cause danger of damage of the engine or other property values.

General safety informations

1. Keep your work area tidy

- Disorder in the work area can lead to accidents.

2. Take environmental influences into account

- Never work with the machine in enclosed rooms or in rooms with poor ventilation. If the engine runs toxic gases are generated. These gases can be odourless and invisible.
- Do not expose the machine to rain.
- Do not use electric tools in a damp or wet environment.
- Take care on your secure footing on uneven ground
- Make sure that the work area is well illuminated.
- Never use the machine in highly flammable vegetation or where fire and explosion hazards exist.
- Provide a fire extinguisher in drought conditions (fire hazard).

3. Keep other persons away

- Do not allow other persons to work with the machine especially children and young people.

4. Securely store unused tools

- Unused tools should be stored in a dry, elevated or closed location out of the reach of children.

5. Do not overload your machine

- They work better and more safely in the specified output range.

6. Wear suitable clothing

- Do not wear wide clothing or jewellery, which can become entangled in moving parts.
- Wear solid working shoes and work gloves. Gloves made out of leather offer good protection.
- Wear protective shoes with steel caps.
- Always wear a working suit made out of solid material.
- Tie long hair back in a hair net and wear a hardhat

7. Wear personal protective equipment

- Always wear a protective headgear, safety goggles, work gloves, non-slip footwear and hearing protection.

8. Avoid abnormal working postures

- In use of the machine ensure on your secure footing.

9. Work in full consciousness

- Do not work with the machine when you are under the influence of alcohol, drugs, medication or other substances which might compromise the vision, dexterity and judgment.

10. Use the machine for its prescribed purpose

- Any other use than intended is deemed to be a case of misuse.

Safety instructions for handling flammable supplies

1. **Warning!** Fuel is highly flammable:
2. Store fuel in containers specifically designed for this purpose.
3. Refill the gasoline tank only outdoors and do not smoke meanwhile.
4. Add fuel before starting the engine. Never remove the cap of fuel tank or add fuel while the engine is running or when the engine is hot.
5. If fuel is spilled, do not attempt to start the engine but move the machine away from the area of spillage and avoid creating any source of ignition until fuel vapours have dissipated. Replace all fuel tank and container caps securely.

Adding fuel

- Always switch off the engine before refuelling.
⚠ Attention! Always open the fuel filler cap carefully to decompose slowly the excess pressure.
- Whilst working with the machine high temperatures can attain on the case. Allow the engine to cool before refuelling.

⚠ Attention! In case of insufficient cooling of the machine the fuel may ignite and lead to serious burns during refueling.

- Make sure not to fill the tank with too much fuel. Immediately remove the fuel and clean the machine when spilling fuel.
- Always close the screw plug on the fuel tank in order to avoid loosening which may occur by vibrations when using the machine.

⚠ DANGER

Never refuel the engine nearby open flames. Additional safety instructions while hand-ling with combustion engines

⚠ DANGER

Combustion engines constitute a special danger during operation and refuelling. Always read and note the warnings. Failure to do so can lead to serious or even deadly injuries.

1. No changes may be made to the machine.

2. **⚠ Attention!**

Danger of poisoning, Emissions, fuels and lubricants are toxic. Emissions shall not be inhaled.

3. **⚠ Attention!**

Risk of burns. Do not touch the exhaust system or drive unit.

4. Never operate the machine in non ventilated rooms or in a highly inflammable environment. If you intend to operate the machine in rooms with good ventilation, the exhaust gases must be channelled directly outdoors through an exhaust hose.

⚠ Attention! Toxic exhaust gases can escape despite the exhaust hose. Due to the fire hazard, never direct the exhaust hose towards inflammable materials.

5. **⚠ Risk of explosion!**

6. Never operate the machine in rooms with combustible materials.
7. Secure the machine against shifting and toppling during transport.
8. Make sure that when you refuel the machine no fuel is spilt on the engine or exhaust pipe.
9. Repairs and adjustment work may only be carried out by authorized trained personnel.
10. Do not touch any mechanically driven or hot parts. Do not remove the safety guards.

11. The values quoted in the technical data under sound power level (L_{WA}) and sound pressure level (L_{PA}) are emission values and not necessarily reliable workplace values. As there is a correlation between emission and immission levels, the values cannot be taken to reliably determine the possible need for additional precautions. Factors influencing the current immission level of the user/operator include the properties of the work area, other sound sources etc., e.g. the number of machines and other neighboring processes, and the time span over which the user/operator is subjected to the noise. Also, the permitted immission level can vary from country to country. Nevertheless, this information makes it possible for the user to be able to make a better assessment of the dangers and risks involved.

12. Never put any items into the ventilation openings. This applies even when the machine is switched off. Non-observance may lead to injury, or damage to the machine.

13. Keep the generator free of oil, dirt and other impurities.

14. Ensure the sound absorber and air filter work properly. These parts serve as flame protection in case of misfire.

15. Stop the engine:

- whenever you leave the machine
- before refueling

16. Always close the fuel valve when the machine is not in operation.

17. Never use the choke lever to stop the engine.

Additional safety instructions

Remaining hazards

The machine has been built using modern technology in accordance with recognized safety rules. Some remaining hazards, however, may still exist.

- Even when all safety measures are taken, some remaining hazards which are not yet evident may still be present.
- Remaining hazards can be minimized by following the safety instructions as well as the instructions in the chapter Authorized use and in the entire operating manual.
- Always keep hands away from the work area when the machine is running.
- Thoroughly inspect the area to be worked, keep the working area clean and free of debris to prevent tripping. Operate on a flat level ground.
- Never place any part of your body where it would be in danger if movement should occur during assembly, installation, and operation, maintenance, repairing or moving.
- Keep all bystanders, children, and pets at least 23 meters (75 feet) away. If you are approached, stop the unit immediately.
- Do not mount on dump box and never carry passengers.
- Never park the machine in a place with unstable ground which could give way, particularly when it is full.
- Disengage clutch lever before starting the engine.
- Start the engine carefully according to instructions and with feet well away from the moving parts.
- Never leave the operating position when the engine is running.
- Always hold the unit with both hands when operating. Keep a firm grip on the handlebars. Beware that the machine may unexpectedly bounce upward or jump forward if the machine should strike buried obstacles such as large stones.
- Walk, never run with the machine.
- Do not overload the machine capacity. Drive at a safe speed, adjusting the speed to the slope of the land, the surface conditions of the road, and the weight of the load.
- Use extreme caution when in reverse or pulling the machine towards you.
- Exercise extreme caution when operating on or crossing gravel drives, walks, or roads. Stay alert for hidden hazards or traffic.
- On soft ground, drive at the first forward/reverse gear. Do not rapidly accelerate, turn sharply or stop.

Safety informations service/ maintenance and storage

1. Only original parts may be used for maintenance and accessories.
2. Replace faulty silencers.
3. Before using, always visually inspect to see that the tools are not worn or damaged. Replace worn or damaged elements and bolts. Keep all nuts, bolts and screws tight to be sure the machine is in safe working condition.
4. Regularly check for leakage or traces of abrasion in the fuel system, such as porous pipes, loose or missing clamps and damage to the tank or tank cap. Before use all defects must be repaired.
5. Before checking or adjusting the machine or the engine, the ignition plug and the ignition wire respectively must be removed to prevent accidental starting.

Storage

1. Never store the machine with fuel in the tank inside a building where fumes can reach an open flame or spark.
2. Allow the engine to cool before storing in any enclosure.
3. To reduce the fire hazard, keep the engine, silencer, battery compartment and fuel storage area free of vegetative material and excessive grease.

Long term storage/hibernation

1. In case of long term storage drain out all of the fuel. Fuels are chemical compounds which change their properties during prolonged storage. If the fuel tank has to be drained out this should happen outdoors.

WARNING

Improper maintenance or ignoring / not rectifying a problem during the operation may become a source of danger. Only operate your machine if it has been regularly maintained. This way, you can ensure that the machine is operating safely, economically and without malfunctions

Do not clean, maintain, setup or repair the machine whilst running. Moving parts may cause serious injuries. Do not use fuel or other flammable solvents to clean the machine.

WARNING

Vapours of fuels and solvents may explode.

Refix the security and safety machine after reparation and maintenance work.

Keep the machine in safe work condition. Especially check the fuel system for tightness.
Always remove any dirt from the cooling fins of the engine.

Residual risks and accident prevention standards. Neglect of ergonomic principles

Negligent handling of personal protective equipment

Negligent handling or omission of the personal protective equipment may cause serious injuries.
– Wear prescribed personal protection equipment.

Human behaviour, misbehaviour

Ensure you are concentrating during any work you are doing.

⚠ **Residual risks** - Cannot be entirely excluded.

Electrical residual risks

Electrical contact

Touching the spark plug may cause an electrical shock.
– Never touch the spark plug while the engine is running.

Thermal residual risks

burns, chilblains

Touching of the exhaust/ case may cause burns.
– allow engine driven machines to cool.

Danger from noise

hearing damage

Prolonged unprotected work with the machine may cause hearing damage.
– Always wear ear-muffs

Danger caused by materials and other substances

Contact, inhalation

The emissions of the machine may cause damages to health.
– Only use the engine driven machine outdoors.

Fire, explosion

⚠ Fuel is flammable.

– During work and refuelling smoking and open flames are prohibited.

In case of emergency

In case of a possibly occurring accident take the necessary first aid steps as appropriate and obtain qualified medical aid as quickly as possible.

If you obtain aid please give the following information:

1. Where did it happen?
2. What happened?
3. How many injured?
4. Type of injury?
5. Who is reporting?

6. Technical data

Engine	4.1 kW
Transmission	3F+1R
Load capacity	300 kg
Box length	910 mm
Box width	650 mm
Box Depth	575 mm
Weight	147 kg
Engine Type	4-stroke engine
Idle speed	1800 1/min.
maximum RPM	3600 1/min.
Engine Starters	Recoil starter
Fuel	Unleaded fuel octane number 90 and max. ethanol of 5%
Fuel tank capacity	3.6 l
Required engine oil	SAE 10W-30
Gear oil	SAE30 / 80W-90
Max. slope	12°
Max. oil tank capacity	0.6 l

Subject to technical modifications!

Noise

⚠ **Warning:** Noise can have serious effects on your health. If the machine noise exceeds 85 dB (A), please wear suitable hearing protection.

Information concerning noise emission measured according to relevant standards:

Sound pressure $L_{pA} = 84,7$ dB(A)

Sound power $L_{wA} = 93,8$ dB(A)

Uncertainty $K_{pA} = 3,0$ dB(A)

Wear ear-muffs.

The impact of noise can cause damage to hearing.

Vibration Left Steering Lever $A_{nv} = 3,92$ m/s²

Vibration Right Steering Lever $A_{nv} = 9,92$ m/s²

Uncertainty $K_{pA} = 1,5$ m/s²

The specified vibration emission value has been measured according to a standardised testing procedure and can be used for comparison of one electric tool with another. The specified vibration emission value

can also be used for an initial assessment of the load.

⚠ WARNING

The vibration emission value can vary from the specified value during the actual use of the electric tool, depending on the type and the manner in which the electric tool is used. Try to minimise stress from vibrations as low as possible. Some examples of means for reducing the vibration stress are wearing gloves while using the tool and limiting work time. In the process all parts of the operating cycle must be taken into account (such as times in which the electric tool is switched off or time in which it is switched on, but is not running under a load).
Limit the noise and vibration to a minimum!

7. Unpacking

Open the packaging and remove the machine carefully.

Remove the packaging material as well as the packaging and transport bracing (if available)

Check that the delivery is complete.

Check the machine and its spare parts for possible damage caused by transportation. In the event of complaints, you must contact the distributor without delay. Claims at a later stage will not be accepted.

If possible, store the packaging until the warranty period has expired

Before handling the machine, make yourself familiar with it by reading the operating instructions.

For accessories, consumables and spare parts, only use original parts. Spare parts are available from your stockist.

Include our item number, the machine model and year of manufacture in your order.

⚠ Attention!

The machine and packaging materials are not toys! Children must not be allowed to play with plastic bags, film and small parts! There is a risk of swallowing and suffocation!

8. Before starting the machine

The following assembly instructions enable you to assemble the machine in just a few minutes.

Steering rod (fig. 21)

Align the drilled holes of the steering rod with the drilled holes of the side parts and secure the steering rod using the screws (pos. A M10 x 45 mm and pos. B M10 x 25), washers, and nuts.

Wheels (fig. 6)

Push the wheels (10) onto the wheel screws and fasten them with the included washers and lock nuts (M12).

Transport tray (fig. 22)

Push the transport tray (8) laterally into the holders provided for this purpose using the guide bolts. Secure these using the included splints.

Gear selector lever (fig. 18)

Slide the gear selector lever (7) through the slot of the switch plate. Fasten the gear selector lever on the inside of the switch bracket using the screws (M8 x 30 mm).

On/off switch cable (fig. 23)

Fasten the on/off switch cable using the included cable connectors.

⚠ ATTENTION!

Always check before starting the engine:

- Check the fuel level and top it up if necessary
 - the tank (21) should be at least half filled
- Make sure that the machine has sufficient ventilation
- Make sure that the ignition cable (25) is secured to the spark plug (13)
- Condition of the air filter
- Condition of the fuel lines
- The external bolt connections for tightness

Filling with fuel

Recommended fuel

Fill the fuel tank (21) with clean fuel with min. 90 octane and max. 5% bio-ethanol content.

⚠ NOTE

Fill the tank not more than 12.5mm (1/2") below of the bottom of the filler neck to provide space for expansion.

Use only fresh and clean fuel.

⚠ Attention!

Water or impurities in the fuel could damage the fuel system.

⚠ **Refuel in a well-ventilated area with the engine stopped. If the engine has been running, allow it to cool first. Never refuel the engine inside buildings where gasoline fumes may reach flames or sparks.**

Fuel is highly flammable and explosive. You can get burned or other serious injuries when handling fuel.

- Switch off the engine and keep it away from heat, sparks and flames.
- Refuel the engine only outdoors.
- Immediately clean up spilled fuel.

9. Functions and controls

⚠ Important!

The machine must be fully assembled before the first use!

Please also refer to the engine manual

Engine switch (Fig.1/Pos.2)

The engine switch (2) enables and disables the ignition system. The engine switch (2) must be in "ON" position to start the engine. The engine switch (2) must be in the "OFF" position to stop the engine.

Clutch control lever (Fig.1/Pos.4)

- Actuating the clutch control lever (4)
 - Clutch is engaged (Press the latch (Figure 8 / A), then you can press the clutch control lever downwards)
- Release the clutch control lever (4)
 - Clutch is disengaged.

Throttle control (Fig.1/Pos.1)

- Put the throttle control (1) on low speed (L) or high speed (H) or an intermediary position between L and H to increase or decrease the speed of engine.

Left steering lever (Fig.1/Pos.5)

Operate the lever (5) to turn left.

Right steering lever (Fig.1/Pos.3)

Operate the lever (3) to turn right.

Gear selection lever (Fig.1/Pos.7)

- The gear selection lever (7) controls forward or reverse movements of the machine.

Fixation dump box (Fig.3/Pos.6)

- Pull the fixation dump box (Fig. 3/pos. 6) with the right hand in direction A1 and unlock the tipper lever (B).
- After unlocking the dump box (8) it can be emptied by tilting (see Fig.2 pos.A3).



⚠ NOTE

If full loading or transporting heavy loads, the emptying of the dump box (8) is carried out with the help of a second person.

- After emptying the dump box (8) you can lower it as shown in Fig. 2 Pos.A4. Lock the dump box (8) by selecting the fixation dump box (6) to position (A2) as shown in Fig. 3.

Starting engine (Fig.1/4/14)

Cold starts

- Turn the choke lever (16) at the engine to position  (Fig.14).
- Set the throttle lever (1) at the handlebar to half-way position.
- Turn the engine switch (2) to "ON" position.
- Set the fuel cock (15) to position .
- Pull the starting rope (18) slowly several times to allow the fuel to flow into the engine's carburetor.
 - Hold the start handle (18) firmly and pull the rope out a short distance until you feel some resistance.
 - Pull the rope smoothly and briskly, and allow the rope to return gently. Do not let the rope snap back. If necessary, pull the rope several times until the engine starts.
- Allow the engine to run for several seconds to warm up.
- Allow the engine to run for several seconds to warm up. Then, gradually move choke lever (16) to position .

⚠ NOTE

If the engine is already warm, it is not required to use the choke for re-starting.

Warm starts

- Set the throttle lever (1) on the handlebar at half-way position.
- Turn the engine switch (2) to pos. "ON".
- Set the fuel cock (15) to the position .
- Pull the starting rope (18) slowly several times to allow the fuel to flow into the engine's carburetor.
- Pull the rope smoothly and briskly, and allow rope to return gently. Do not let the rope snap back.

Operating

- After the engine warms up, pull the throttle lever (1) to accelerate the engine speed (shown Fig.1 pos.H).
- Engage the required gear (7) and slowly squeeze the clutch control lever (4). Press the latch (Fig. 8 Pos.A) to operate with the clutch lever (4). If the gear does not engage straight away, slowly release the clutch lever (4) and try it again.

Steering

The dumper has the steering levers (3)+(5) on the handlebars and this makes steering very easy. To turn right or left, simply operate the corresponding right (3) or left (5) steering lever.

The sensitivity of the steering increases in proportion to the speed of the machine and that with the empty machine, a light pressure on the lever is all that is needed to turn. While when the machine is loaded, more pressure is required.

⚠ Attention!

The dumper has a maximum load capacity of 300kg. However, it is advisable to assess the load and adjust it according to the ground on which the machine will be used.

It is therefore advisable to cover such stretches using low gear and taking extra care. Avoid sharp turns and frequent changes of the direction while driving on the road, in particularly on rough, hard terrains full of sharp, uneven points with a high degree of friction.

Remember that the unit has all-wheel drive but you need to be careful when working under adverse weather conditions (ice, heavy rain and snow) or at soil types that can lead to instability of the dumper.

Please note that this is a wheeled vehicle that considerable pitching when driving over bumps, holes and steps subject.

When the clutch control lever (4) is released, the machine will stop and brake automatically.

If you stop the machine on a steep slope, you should position a wedge in the direction of fall to secure the machine.

Idle speed

Set the throttle control lever (1) to its "L" position to reduce stress on the engine when working is not being performed.

Lowering the engine speed to idle the engine will help extend the life of the engine, as well as conserve fuel and reduce the noise level of the machine.

Stopping engine

⚠ Attention!

To stop the engine in case of emergency, simply turn the engine switch (2) to the "OFF" position.

Under normal conditions, use the following procedure.

- Move the throttle lever (1) to the "L" position.
- Let the engine idle for one or two minutes.
- Turn the engine switch (2) to the "OFF" position.
- Turn the fuel valve lever (15) contrary to the position. 

⚠ NOTE

Do not move the choke control (16) to stop engine. Backfire or engine damage may occur.

10. Cleaning

Caution!

Switch off the engine and pull the spark plug boot from the spark plug before doing any cleaning and maintenance work on the machine.

Keep all safety machines, air vents and the engine housing free of dirt and dust. Wipe the machine with a clean cloth or clean it with compressed air at low pressure.

We recommend that you clean your machine after each use.

Clean the unit regularly with a damp cloth and some soft soap. Do not use cleaning agents or solvents; they may damage the plastic parts of the machine. Make sure that no water can get inside the unit.

11. Transport

⚠ WARNING

Let the engine cool down before transporting the machine or storing indoors to avoid burns or fire hazards. If you want to transport the machine empty the fuel tank before. Clean the unit with a brush or a broom of coarse dirt.

12. Storage

Store the machine and its accessories in a dark, dry and frost-proof place that is inaccessible to children. The optimum storage temperature is between 5 and 30°C.

Cover the machine in order to protect it from dust and moisture. Store the operating manual with the machine.

1. Perform all general maintenance, which are in the User's Guide in the Maintenance section.
2. Let the fuel out of the tank (Use a commercially plastic fuel pump from the hardware store).
3. After the fuel is drained, start the machine.
4. Let the machine in running in idle speed until it stops. This cleans the carburetor from the remaining fuel.
5. Let the machine cool down. (about 5 minutes)
6. Remove the spark plug.
7. Fill a small amount of 2-stroke engine oil into the firing chamber. Pull out several times the starter cord gently to wet the internal components with the oil.
8. Replace the spark plug.
9. Clean the outer casing of the machine.

⚠ Do not use strong detergents or petroleum based cleaners when cleaning plastic parts. Chemicals can damage plastics.

10. Store your machine on a straight bottom in a clean, dry building with good ventilation.

⚠ Do not store the machine with fuel in a non-ventilated area where fuel fumes may reach flame, sparks, pilot lights or any ignition sources.

Recommissioning

1. Remove the spark plug.
2. Pull the starter rope out several times. It cleans the firing chamber of oil residues.
3. Clean the spark plug contacts or install a new spark plug.
4. Fill the tank.

13. Maintenance

Caution!

Switch off the engine and pull the spark plug boot from the spark plug before doing any cleaning and maintenance work on the machine.

Important hint in case of sending the machine to a service station:

Due to security reasons please see to it that the machine is sent back free of oil and gas!

A proper maintenance and lubrication will help the machine in a perfect working condition.

Preventive maintenance

⚠ Warning

Turn off engine and disengage all command levers. Engine must be cooled down. Disconnect the spark plug cap (25) from the spark plug (13) (see Fig. 15). Inspect the general condition of the unit. Check for loose screws, misalignment or binding of moving parts, cracked or broken parts, and any other condition that may affect its safe operation.

Remove all debris and other materials that may have accumulated to the wheels and unit. Clean after each use. Then use a premium quality lightweight machine oil to lubricate all moving parts.

⚠ Never use a "pressure washer" to clean your unit. Water can penetrate tight areas of the machine and its transmission case and cause damage to spindles, gears, bearings, or the engine. The use of pressure washers will result in shortened life and reduce serviceability.

Adjusting the clutch (Fig.16)

As the clutch wears out, the same lever could have a wider opening, being so uneasy to use. This means that it is necessary to adjust the cable, setting clutch lever on its original position acting on the adjustment device (26) and on counter-nut (27).

Adjusting the steering (Fig.17)

If you have difficulty steering the unit, you will need to adjust the steering levers (3) + (5) with the special adjusters (26). Slacken off the locknut (27) and unscrew the adjusters (26) to eliminate the play in the cable, which can occur after initial use or normal wear. Be very careful not to unscrew the adjusters (26) too much because this can create another problem: the loss of traction. Remember to tighten the locknut (27) when you have finished.

Lubrication

The gearbox is pre-lubricated and sealed at the factory.

Oil changes

Changing the transmission oil

The oil must be replaced every 1000 hours with the engine still warm. If necessary leave the engine running for a short time.

- Place a suitable container with a minimum of 2 litre capacity under the oil drain plug (see Fig.12 Pos.28).
- Open the oil drain plug (28) and then the oil filler neck (29) and leave the entire engine oil flow (Fig.13).
- Close the oil drain plug (28) again.

- Fill 1.62 litres of clean transmission oil into the oil filler neck (29). To do this, use a gear oil pump with hose. Insert the hose through the opening in the oil filler neck (see Fig.13).

Engine Oil

Check the oil level before each use. Remove the oil dipstick (23) and check the machine in horizontal position that the oil level is between the two marks. If necessary, add oil.

Changing the engine oil

The oil must be replaced every 50 hours. For this the engine must be warm and stopped. For this run engine for a short time. Afterwards drain oil into a suitable container. For this purpose remove the dipstick (Fig. 18 pos.23) and the oil drain plug (Fig. 18 pos.22). Maybe take a suitable hose or tube to help. After the oil has been completely drained mount the oil drain plug (22) again, fill in new oil and close the oil filler cap (23).

Recommended engine oil

SAE 10W-30 or SAE 10W-40 (depending on application temperature).

Dispose of waste oil properly at the local used oil collection point. It is forbidden to discharge waste oil into the ground or mixed with other waste.

Important hint in case of sending the machine to a service station:

In case of delivery, please note that the unit must be free of oil and fuel to ensure safe shipment.

Air filter

Frequently cleaning of the air filter prevents carburetor malfunction.

Clean the air filter and change air filter inserts (Fig. 19 and 20)

- The air filter (14) should be cleaned every 30 hours.
- Remove the air filter cover (Pos.A) by loosening the thumbscrew (Pos.B1)
- Loosen the thumb screw (Pos.B2) and remove the air filter (14)
- Clean the air filter by tapping , replace if necessary.
- Reassemble it in reverse order.

⚠ WARNING

NEVER use gasoline or cleaning solvents with a low flash point to clean the air filter element. A fire or explosion could result.

Note

Never run the engine without or with a damaged air filter. Dirt gets so into the engine, causing serious engine damage can occur. In this case, seller, and man-

ufacturer disassociate from any warranty.

Check, clean and replace spark plug (13) (Fig.11/15)

Check the spark plug (13) after 10 hours on dirt and grime. If necessary, clean it with a copper wire brush. Maintenance the spark plug after 50 hours of operation.

- Remove the spark plug ignition cable (25).
- Remove any dirt from the base of the spark plug (13).
- Use a wrench to remove the spark plug (13).
- Check the spark plug (13) visually. Remove any debris with a wire brush.
- Look for discolouration on the top of the spark plug. By default, the colour should be bright.
- Check the spark plug gap. An acceptable gap width is 0.6 to 0.7 mm (see Fig.11).
- Remove the spark plug (13) carefully by hand.
- If the spark plug (13) has been inserted, tighten them with a spark plug wrench.
- Attach the spark plug connector (25) at the spark plug (13).

Note

A loosen spark plug can overheat and damage the engine. And over tightening the spark plug can damage the threads in the cylinder head.

Lubrication drive chain (Fig.9-10)

Remove the cover (Fig.9 Pos.A) concerning the screws (19). Regrease drive chain (24) every 500 operating hours. Recap the opening with the lid (Fig.9 Pos.A) and the screws (19) after servicing.

Disassembling wheels (Fig.6)

For maintenance disassemble the wheels as shown in figure 6.

Please note that the following parts of this product are subject to normal or natural wear and that the following parts are therefore also required for use as consumables.

Wear parts*: spark plug, belt

* Not necessarily included in the scope of delivery!

14. Disposal and recycling

The machine is supplied in packaging to prevent it from being damaged in transit. The raw materials in this packaging can be reused or recycled. The machine and its accessories are made of various types of material, such as metal and plastic.

Defective components must be disposed of as special waste. Ask your dealer or your local council.

15. Troubleshooting

The table below contains a list of error symptoms and explains what you can do to solve the problem if your tool fails to work properly. If the problem persists after working through the list, please contact your nearest service workshop.

Problem	Possible Cause	Remedy
Engine fails to start	Spark plug wire disconnected.	Attach spark plug wire securely to spark plug.
	Out of fuel or stale fuel.	Fill with clean, fresh gasoline.
	Choke not in open position.	Throttle must be positioned at choke for a cold start.
	Blocked fuel line.	Clean the fuel line.
	Fouled spark plug.	Clean, adjust gap, or replace.
	Engine flooding.	Wait a few minutes to restart, but do not prime.
Engine runs erratically.	Spark plug wire loose.	Connect and tighten spark plug wire.
	Unit running on CHOKE.	Move choke lever to OFF.
	Blocked fuel line or stale fuel.	Clean fuel line. Fill tank with clean, fresh gasoline.
	Vent plugged.	Clear vent.
	Water or dirt in fuel system.	Drain fuel tank. Refill with fresh fuel.
	Dirty air cleaner.	Clean or replace air cleaner.
	Improper carburetor adjustment.	Consult the service.
Engine overheats.	Engine oil level low.	Fill crankcase with proper oil.
	Dirty air cleaner.	Clean air cleaner.
	Air flow restricted.	Remove housing and clean.
	Carburetor not adjusted properly.	Consult the service.
Machine does not move while engine is running.	Gear is not properly selected.	Ensure gear lever is not in-between two different gears.
	Driving tracks not tight enough.	Tighten driving tracks.

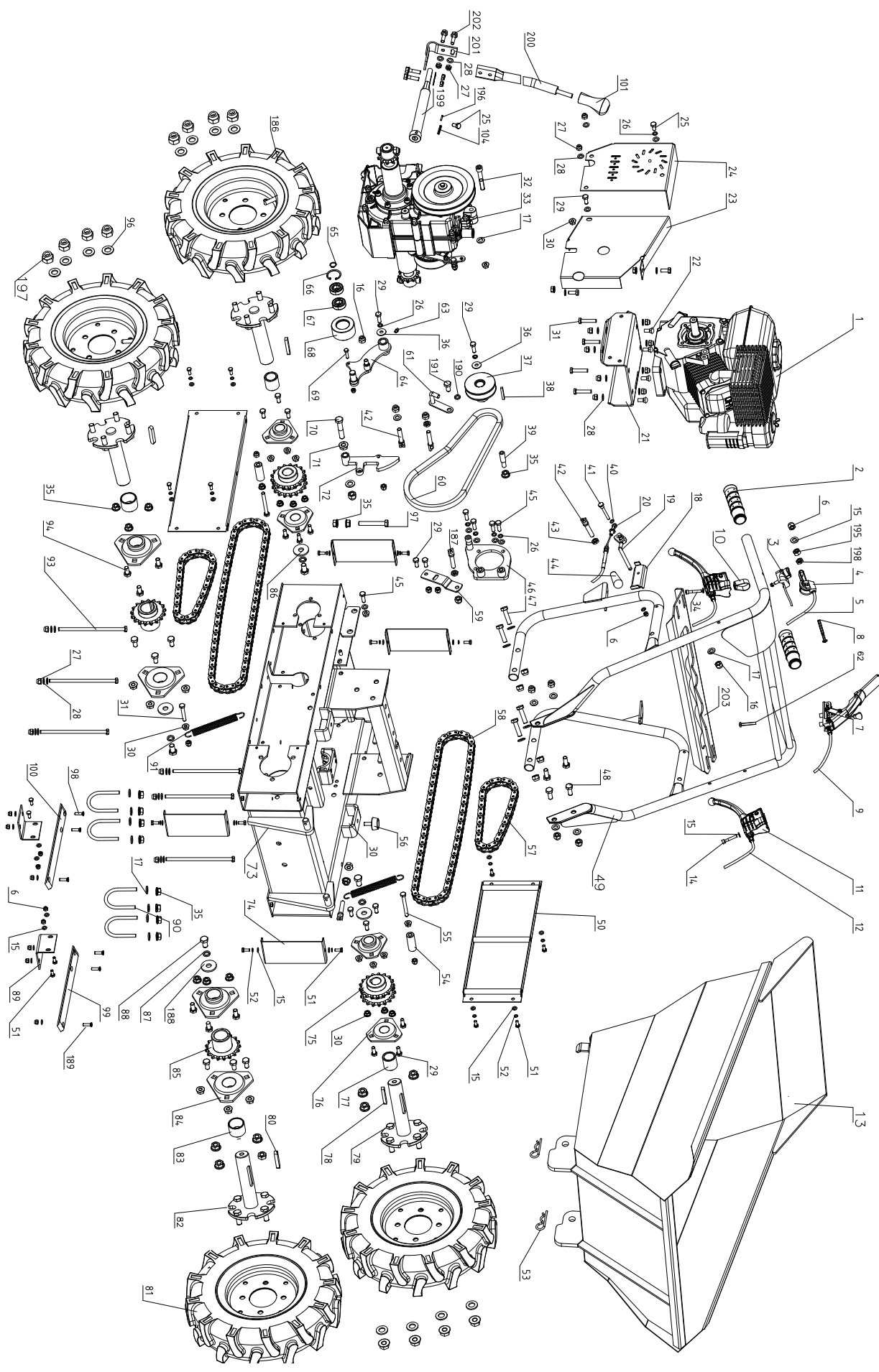

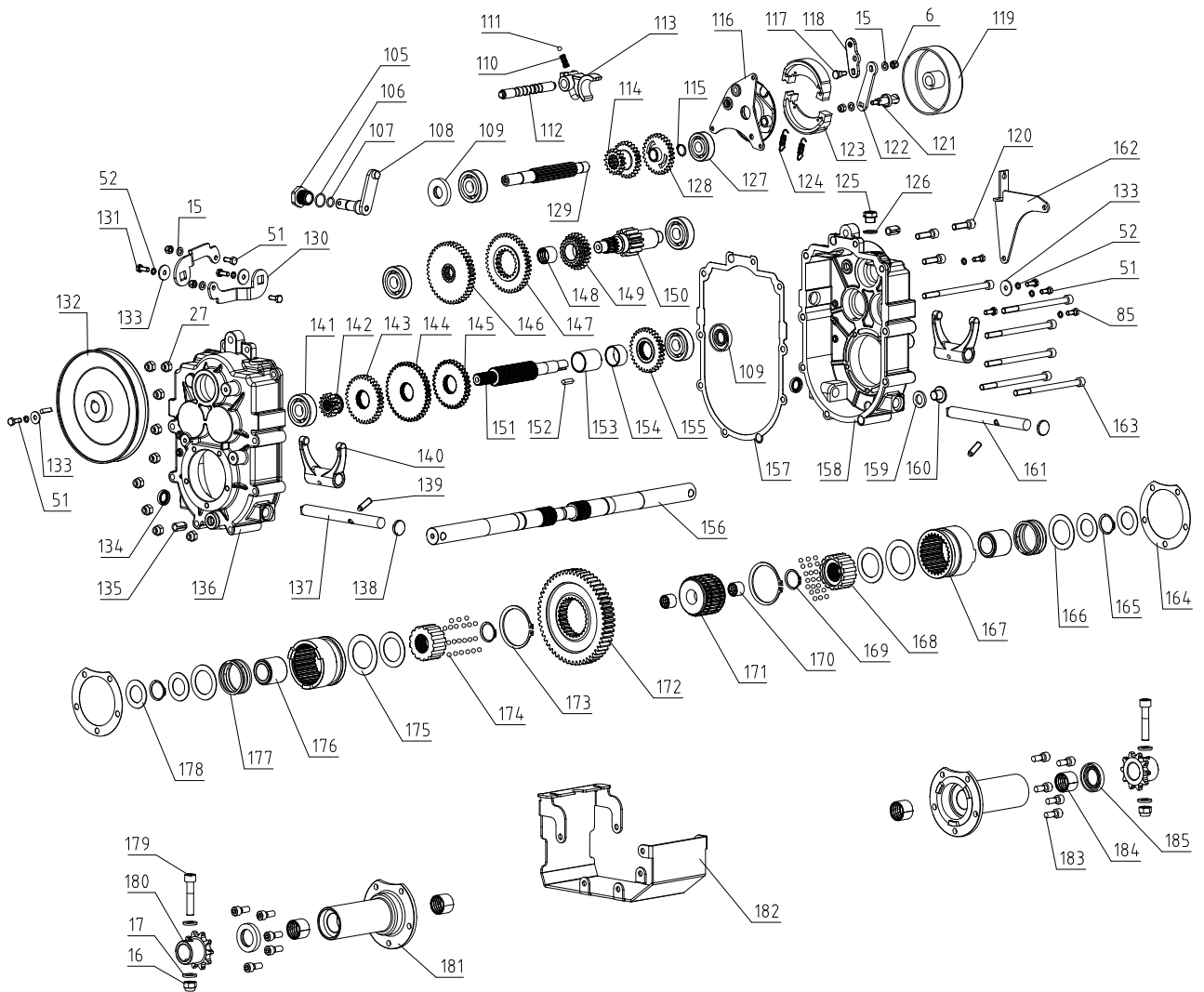



DUMPER

Warranty Details

The product is guaranteed to be free from defects in workmanship and parts for a period of 12 months from the date of purchase. Defects that occur within this warranty period, under normal use and care, will be repaired, replaced or refunded at our discretion. The benefits conferred by this warranty are in addition to all rights and remedies in respect of the product that the consumer has under the Competition and Consumer Act 2010 and similar state and territory laws.

Our goods come with guarantees that cannot be excluded under the Australian Consumer Law. You are entitled to a replacement or refund for a major failure and for compensation for any other reasonably foreseeable loss or damage. You are also entitled to have the goods repaired or replaced if the goods fail to be of acceptable quality and the failure does not amount to a major failure.

AFTER SALES SUPPORT

 1300 855 831

 support@scheppach.com.au

AU Hotline Costs: Local rate for landline calls*

*Charges may vary dependent upon network operator or mobile network provider.





DUMPER

Repair and Refurbished Goods or Parts Notice

Unfortunately, from time to time, faulty products are manufactured which need to be returned to the Supplier for repair.

Please be aware that if your product is capable of retaining user-generated data (such as files stored on a computer hard drive, telephone numbers stored on a mobile telephone, songs stored on a portable media player, games saved on a games console or files stored on a USB memory stick) during the process of repair, some or all of your stored data may be lost.

We recommend you save this data elsewhere prior to sending the product for repair.

You should also be aware that rather than repairing goods, we may replace them with refurbished goods of the same type or use refurbished parts in the repair process.

Please be assured though, refurbished parts or replacements are only used where they meet Scheppach's stringent quality specifications.

If at any time you feel your repair is being handled unsatisfactorily, you may escalate your complaint. Please telephone us on "1300 855 831" or write to us at:

RossMac Pty. Ltd.
P.O. Box 261, Essendon North, Victoria, 3041
Telephone: 1300 855 831 (Monday - Friday 8:30am-6:00pm)
Email: support@scheppach.com.au

AFTER SALES SUPPORT

 1300 855 831

 support@scheppach.com.au

AU Hotline Costs: Local rate for landline calls*

*Charges may vary dependent upon network operator or mobile network provider.



AFTER SALES SUPPORT

706623



1300 855 831



support@scheppach.com.au

MODEL:
DP3000

09/2021

