



User Manual

Contents

ALDI guarantees that our exclusive brand products are developed to our stringent quality specifications. If you are not entirely satisfied with this product, please return it to the nearest ALDI store within 60 days from the date of purchase, for a full refund or replacement, or take advantage of our after sales support by calling the supplier's Customer Service Hotline.

FERREX® PETROL BLOWER VACUUM LBH2600P



- Overview/Utilisation04
- Utilisation05
- Contents of box06
- Explanation of symbols08
- Introduction09
- Layout10
- Unpacking.....10
- Intended use11
- General Safety Warnings12
- Technical data15
- Attachment and operation16
- Working instructions23
- Maintenance24
- Storage27
- Disposal and recycling27
- Troubleshooting28
- Warranty Details30
- Repair and Refurbished Goods or Parts Notice32

AUS

Made in China

FERREX® is a registered trademark of ALDI Stores

DISTRIBUTED BY:

ALDI STORES

1 SARGENTS ROAD

MINCHINBURY NSW 2770

www.aldi.com.au

AFTER SALES SUPPORT

706300

AUS 1300 855 831

support@scheppach.com.au

MODEL:
LBH2600P

10/2021

1
YEAR
WARRANTY



CAUTION!: Read the manual carefully before operating this machine!

Vers.No. 210324

Original Instructions



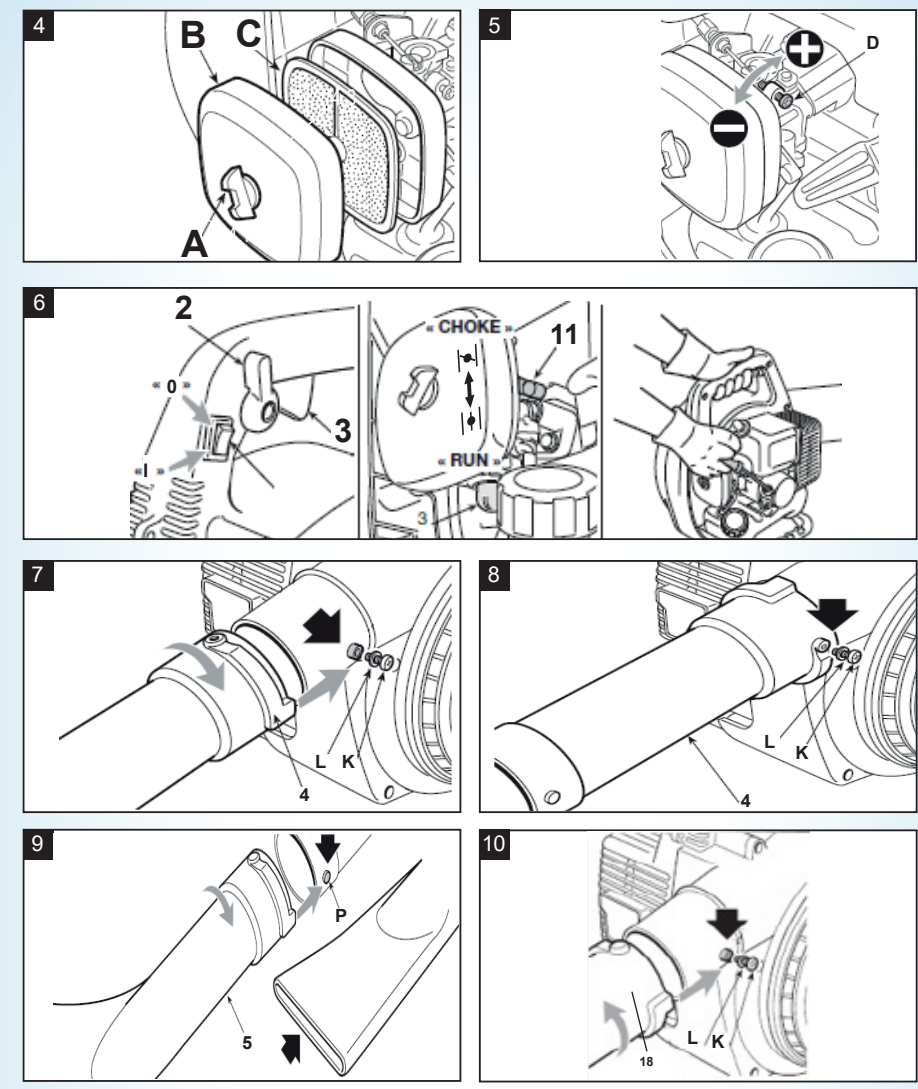
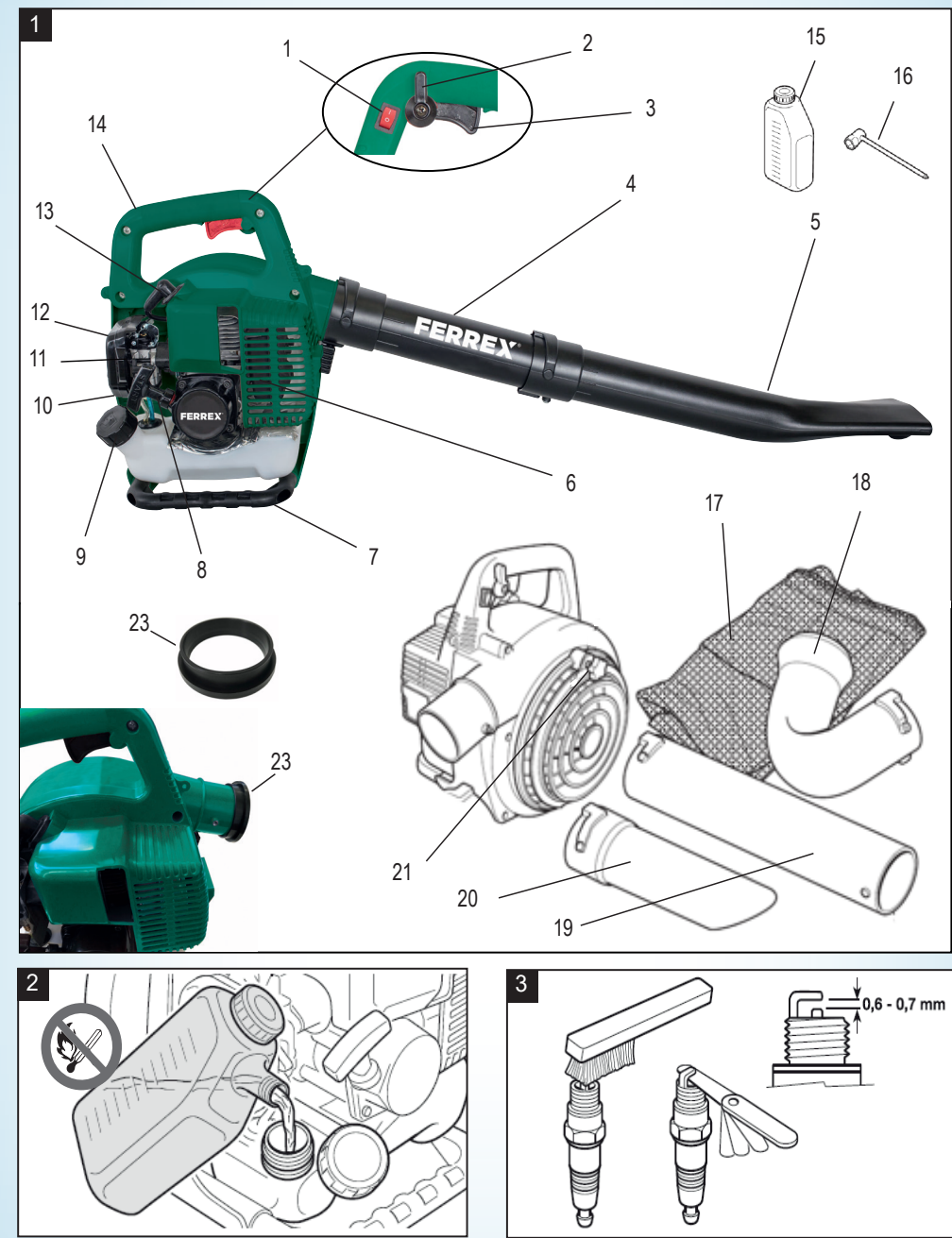

Contents of Box

- 1x Motor unit (6)
- 1x First blower tube (4)
- 1x Second blower tube (5)
- 1x Graduated fuel bottle (15)
- 1x Tool with screwdriver and spark plug wrench (16)
- 1x Capacity bag (17)
- 1x Bent tube (18)
- 1x Vacuum tube (19)
- 1x Suction vacuum tube (20)

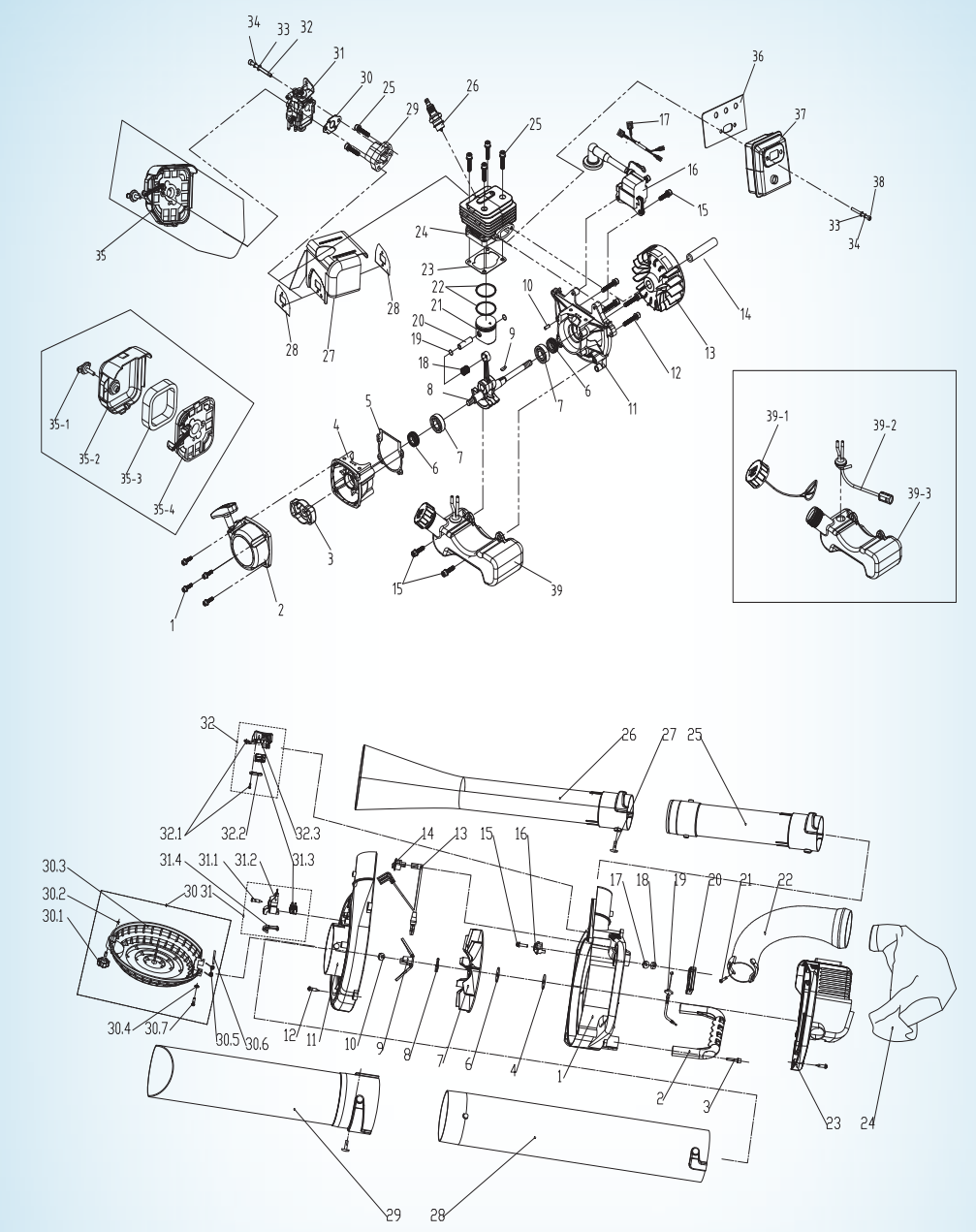

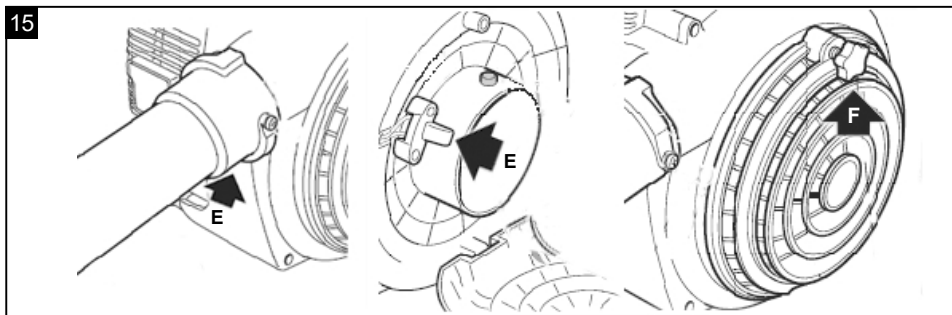
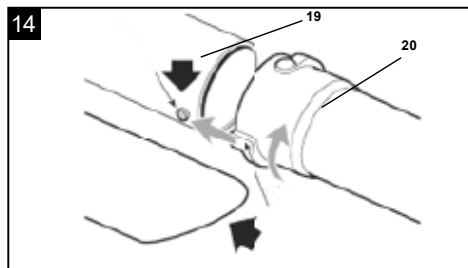
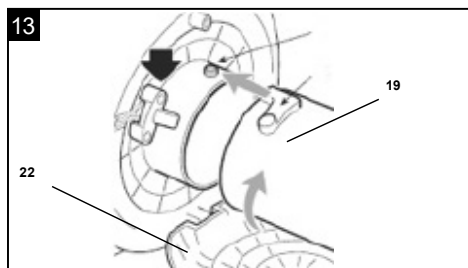
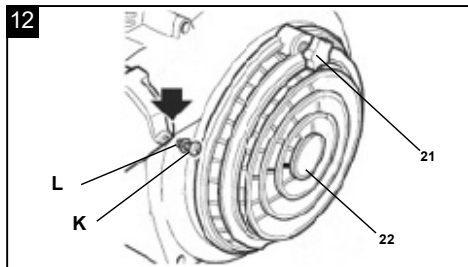
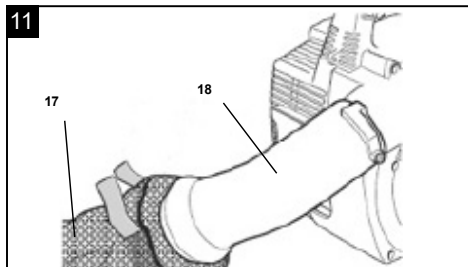

Explanation of symbols



Read and observe operating instructions and safety instructions before commissioning!



Wear eye protection.



Warning! Denotes risk of personal injury, loss of life, or damage to the tool in case of non-observance.



Warning! Risk of injury!
Never put your hands close to the blades.



Guaranteed sound power.



Warning! Beware of thrown objects hit by cutting attachments. Never use without properly mounted blade guard.



Warning! The exhaust and other parts of the engine will get very hot during use, do not touch!



Keep bystanders away.



Wear ear protection.



The RCM Mark (Regulatory Compliance Mark) indicates that the product complies with the relevant guidelines of the ACMA as well as corresponding government requirements for the safety of electrical devices.



Warning! Petrol is very flammable. Avoid smoking or bringing any flame or sparks near petrol.



Before starting the motor, press the fuel pump for 10 times



Wear robust footwear and work gloves when using the device!

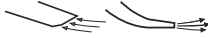

Air speed vacuum/blower.



Warranty class. One year warranty.

I. INTRODUCTION

Congratulations on choosing to buy a FERREX® product.

All products brought to you by FERREX® are manufactured to the highest standards of performance and safety, and as part of our philosophy of customer service and satisfaction, are backed by our comprehensive 1 Year Warranty.

We hope you will enjoy using your purchase for many years to come.

Note:

According to the applicable product liability law the manufacturer of this device is not liable for damages which arise on or in connection with this device in case of:

- improper handling,
- non-compliance with the instructions for use,
- repairs by third party, non-authorized skilled workers,
- installation and replacement of non-original spare parts,
- improper use.

Recommendations:

Read the entire text of the operating instructions prior to the assembly and operation of the device.

These operating instructions are intended to make it easier for you to get familiar with your device and utilise its intended possibilities of use.

The operating instructions contain important notes on how to work safely, properly and economically with your Petrol Blower Vacuum and how to avoid dangers, save repair costs, reduce downtime, and increase the reliability and working life of the Petrol Blower Vacuum.

In addition to the safety regulations contained herein, you must in any case comply with the applicable regulations of your country with respect to the operation of the Petrol Blower Vacuum.

Put the operating instructions in a clear plastic folder to protect them from dirt and humidity, and store them near the Petrol Blower Vacuum. The instructions must be read

and carefully observed by each operator prior to starting the work. Only persons who have been trained in the use of the Petrol Blower Vacuum and have been informed on the related dangers and risks are allowed to use the Petrol Blower Vacuum. The required minimum age must be met.

In addition to the safety notes contained in the present operating instructions and the special regulations of your country, the generally recognised technical rules for the operation of generators must be observed.

II. Layout

1. Engine switch
2. Throttle lockout
3. Throttle control
4. First blower tube
5. Second blower tube
6. Motor unit
7. Lower handgrip
8. Starter handle
9. Fuel tank cap
10. Fuel pump
11. Choke lever
12. Air filter cover
13. Spark plug
14. Upper handgrip
15. Graduated fuel bottle
16. Tool with screwdriver and spark plug wrench
17. Capacity bag
18. Bent tube
19. Vacuum tube (1)
20. Suction vacuum tube (2)
21. Star grip
22. Protection grid
23. Transport protection ring
- L. Washer
- K. Screw

III. Unpacking

- Open the packaging and take out the equipment with care.
- Remove the packaging material and any packaging and/or transportation braces (if available).
- Check to see if all items are present.

- Inspect the equipment and accessories for transport damage. In case of complaints the supplier is to be informed as soon as possible.
- If possible, keep the packaging until the end of the guarantee period.
- Read the operating instructions to make yourself familiar with the device prior to using it.
- Only use original parts for accessories as well as for wearing and spare parts. Spare parts are available from your specialized dealer.
- Specify our part numbers as well as the type and year of construction of the device in your orders.

⚠ Important!

The equipment and packaging material are not toys. Do not let children play with plastic bags, foils or small parts. There is a danger of swallowing or suffocating!

IV. Intended use

- Before starting any work, all protective and safety devices must be in place.
- The blower vac is designed to blow leaves as well as lawn debris such as grass clippings and small twigs. It is not to be used for any other purpose.
- The device is only to be used on dry surfaces.
- The machine has been designed to be operated by one person.
- The operator is responsible for third parties in the area of operations.
- All safety and hazard notices on the machine must be observed.
- All safety and hazard notices on the machine must be kept in a completely legible condition.
- Use the machine in a technically flawless condition only, as well as for its intended purpose, in a safe manner and being aware of dangers, in compliance with the operating instructions!
- Disruptions which can affect safety in particular must be eliminated straight away!
- The manufacturer's safety, operation and maintenance instructions as well as the technical data given in the calibrations and dimensions must be adhered to.
- Relevant accident prevention regulations and other generally recognized safety and technical rules must also be adhered to.
- The machine may only be used, maintained or repaired by trained persons who are familiar with the machine and have been informed about the dangers. Unauthorized modifications of the machine exclude a liability of the manufacturer for damages resulting from the modifications.
- Employ the device suction operating mode only when the capacity bag is attached.
- Do not intake any burning, smouldering or smoking materials (e.g. cigarettes, embers etc.), fumes or easily inflammable, poisonous or explosive materials.
- The machine is intended for use only with original spare parts and original tools from the producer.
- Any other use is considered to be not intended. The manufacturer excludes any liability for resulting damages, the risk is exclusively borne by the user.

- The device must not be used for commercial, technical or industrial applications.
- If you are not sure whether working conditions are safe or unsafe, do not work with the machine.

WARNING! For your own safety, please thoroughly read this manual and the general safety instructions before turning the device on. If you give the device to third parties, always include these instructions.

The equipment is allowed to be used only for its prescribed purpose.

Any other use is deemed to be a case of misuse. The user/operator and not the manufacturer will be liable for any damage or injuries of any kind resulting from such misuse.

V. General Safety Warnings

⚠ CAUTION: Read all safety regulations and instructions. Any failures made in following the safety regulations and instructions may result in an, fire and/or serious injury. Do not use any other fuel than that recommended in your manual. Always follow instructions in the Fuel and Lubrication section of this manual. Never use petrol unless it is properly mixed with 2-cycle engine lubricant. Permanent damage to engine will result, voiding manufacturer's warranty.

Keep all safety regulations and instructions in a safe place for future use.

General instructions

- Read the complete operating manual with due care. Acquaint yourself with the controls and how to use the tool.
- All persons (including children) who, for reasons of physical, sensory or mental ability or inexperience or lack of knowledge, are not in a position to be able to use this device safely, should not use the device unsupervised or without instruction by or from a responsible person. Children must always be supervised in order to ensure that they do not play with the device.
- Never allow children to use the tool.
- Never allow other persons who are not familiar with the operating instructions to use the tool. Contact your local government offices for information regarding minimum age requirements for operating the tool.
- Never use the tool when there are people – particularly children – or pets nearby.
- The user is responsible for any accidents or hazards suffered by third parties or their property.

- Do not wear wide clothing or jewellery. Wear long trousers to protect your legs. Wear safety helmet for long hair. Loose clothing, jewellery, and long hair can get caught in the moving parts. Wear suitable and durable tight working clothes.
- Always switch off the engine when removing the machine and before working on the unit.
- Wear safety goggles while you work.
- Use a dust mask when working on dusty jobs
- Never use the tool if any of its safety devices or guards are damaged or if any safety attachments such as deflectors and/or grass catching devices are missing.

Workplace safety

- Keep your work area clean and well illuminated. Untidy or unlit work areas can result in accidents.
- Do not operate the device in an environment where there is a risk of explosions and where there are inflammable liquids, gases or dust. Device produce sparks which could set the dust or vapours alight.
- Keep the device out of the reach of children and other persons. If there is a distraction, you may lose control of the appliance.

Safety of persons

- Be careful, watch what you are doing and use an device sensibly. Do not use the tool if you are tired or under the influence of drugs, alcohol or medication. A moment of inattention when using the device can result in serious injuries.
- Wear personal protection equipment and always wear safety goggles. Wearing personal protection (such as dust masks, non-slip safety shoes, safety helmet or ear protection, depending upon the type and use of the device) reduces the risk of injury.
- Make sure that the appliance cannot start up accidentally. If your finger is on the switch whilst carrying the device this can lead to accidents.
- Remove keys and wrenches before switching on the device. A tool or key which comes into contact with rotating parts of the appliance can lead to injuries.
- Avoid abnormal working postures. Make sure you stand squarely and keep your balance at all times. In this way, you can control the device better in unexpected circumstances.
- Wear suitable work clothes. Do not wear loose clothing or jewellery. Keep hair, clothes and gloves away from moving parts. Loose clothing, jewellery or long hair can get trapped in moving parts.

Usage and treatment of the device

- Do not overload the appliance. Use the correct tool for your work. You will be able to work better and more safely within the given performance boundaries.
- Do not use an device with a defective switch. An device tool that cannot be switched on or off is dangerous and must be repaired.
- Keep unused device out of the reach of children. Do not allow people who are not familiar with the appliance or who have not read these instructions to use the appliance. Device are dangerous if they are used by inexperienced people.
- Clean your device carefully. Check whether moving parts are functioning properly and not jamming, whether parts are broken or damaged enough that the functioning of this device is affected. Have damaged parts repaired before using the appliance. Many accidents are caused by badly maintained device.
- Make sure to use device, accessories, attachments, etc. in accordance with these instructions. Take the conditions in your work area and the job in hand into account. Using device for any purpose other than the one for which they are intended can lead to dangerous situations.

Safe handling with fuels

Fuels and fuel vapours are inflammable and may cause serious injury on the skin or when inhaled. Therefore be careful and provide sufficient ventilation when handling with fuels.

- Stop the engine and allow the device to cool down before fuelling it.
- Do not smoke and avoid open flames when fuelling. (fig. 2)
- Wear gloves when fuelling.
- Do not fuel in closed rooms. (Danger of explosion)
- Avoid spilling of fuel or oil. Clean the hedge trimmer immediately when you have spilled fuel or oil. Change your clothes immediately when you have spilled fuel or oil on them.
- Make sure that no fuel can come into the soil.
- Carefully close the tank cap after fuelling and check that it does not get loose during operation.
- Check that there is no leakage on the tank cap and fuel lines. If there are leaks this device may not be started.
- Only transport and store fuels in containers approved and identified for this.
- Keep children away from fuels.
- Do not handle and store fuels close to combustible and highly inflammable materials as well as sparks and open flames.
- Go away at least three metres from the fuelling place to start the device.

- To reduce the fire risk keep the motor and silencer free from cutting remainders, leaves and lubricants.
- Keep handles dry, clean and free of fuel mixture.
- Do not refuel a running engine or an engine that is hot.

Residual risks

Even if used properly, residual risks can exist even if the relevant safety regulations are complied with due to the design determined by the intended purpose. Observing these instructions, and taking proper care, will reduce the risk of personal injury or damage to the equipment.

- Injury by catapulted parts.
- Breaking or catapulting of knife pieces.
- Carbon monoxide poisoning when using the device in closed or poorly ventilated rooms.
- Burning when touching hot parts.
- Impairment of hearing when working on the machine for longer periods of time without ear protection.

In addition, in spite of all the precautionary measures taken, non-obvious residual risks can still exist. Residual risks can be minimised if the “Safety information” and the “Intended usage” as well as the whole of the operating instructions are observed.

VI. Technical data

Type	Petrol Blower Vacuum
Dimension LxWxH	1250 x 550 x 370 mm
Air speed max.	260 km/h
dust bag capacity	50 L
Power unit	
Displacement	25.4 cm ³
Max. engine output	0.7 kW
Idle speed	3500 ± 300 min ⁻¹
Fuel tank capacity	650 mL
Engine type	2-stroke engine, air cooled
Blower weight	4.7 kg
Vacuum weight	5.88 kg
Total weight	8 kg

Subject to technical changes!

Information concerning noise emission measured according to relevant standards:

Sound pressure	$L_{PA} = 97 \text{ dB(A)}$
Sound power	$L_{WA} = 108.4 \text{ dB(A)}$
Guaranteed sound power level:	$L_{WA} = 110 \text{ dB(A)}$
Uncertainty	$K_{PA} = 3 \text{ dB(A)}$

Wear ear-muffs.

The impact of noise can cause damage to hearing.

Vibrations:

Lower handle:	$A_{HV} = 15.1 \text{ m/s}^2$
Upper handle:	$A_{HV} = 11.92 \text{ m/s}^2$
Uncertainty	$K_{PA} = 1.5 \text{ m/s}^2$

Reduce noise generation and vibration to a minimum!

- Use only equipment that is in perfect condition.
- Maintain and clean the equipment regularly.
- Adopt your way of working to the equipment.
- Do not overload the equipment.
- Have the equipment checked if necessary.
- Switch off the equipment when not in use.
- Wear gloves.

In these operating instructions we have marked the places that have to do with your safety with this sign: \triangle

VII. Attachment and operating**ATTENTION!**

Before working on the device - cleaning, inspection, maintenance or other work - always turn off the device.

ATTENTION!

Remove transport protection ring (23) Fig. 1

Assembly blower(Fig. 7-9)

\triangle **Warning: The blower must not be used or switched on until it has been fully assembled.**

- Remove the screw (K) and its washers (L).
- Align the first blower tube(4) compartment with the protrusion of the air outlet, push

the tube and turn it 90° clockwise, in order to permanently fix it in place.

- Fix the first blower tube (4) to the air outlet using the screw (K) and its washers (L).
- Align the second blower tube(5) compartment with the protrusion (P) of the first blower tube, push the tube and turn it 90° clockwise, in order to permanently fix it in place.

⚠ Warning! Use only original manufacturer's replacement parts, accessories and attachments. Failure to do so can cause poor performance, possible injury and may void your warranty. Never use the machine without the guard assembled!

Leaf blower

Assembly: (Fig. 6 - 10)

⚠ WARNINGS: The device must not be switched on or used until it has been fully assembled.

Assembly vacuum collector (Fig. 10 - 14)

Warning: The vacuum collector must not be used or switched on until it has been fully assembled.

- Remove the screw (K) and the washer (L).
- Align the bent tube (18) with the projection of the air outlet, then slide the bent tube over the air outlet and turn it over 90 ° counterclockwise to make it permanent to fix.
- Insert the bent tube end into the capacity bag (17) and close the opening with the hook and loop tape, which is fixed at the capacity bag (17).
- The bent tube (18) with the screw (K) and the washers (L) secure to the air outlet.
- Release the star grip (21) and remove the protection grid (22) to open.
- Align the vacuum tube (19) with the projection from the inlet, slide the vacuum tube in the direction of the projection and turn it 90° clockwise to fix it permanently.
- Align the second suction vacuum tube (20) with the slide out the projection of the first vacuum tube (19). After this put the two tubes together and turn them 90 ° clockwise to make them permanent fix.
- The engine can not start if you do not assemble the vacuum tube when using as a vacuum.

Operation

Before starting

Each time before use, check the following:

- That there are no leaks in the fuel system.
- That the equipment is in perfect condition and that the safety devices and cutting devices are complete.
- That all screws are securely fastened.

- That all moving parts move smoothly.
- That the protective flap (E) is closed and that all security switches (F) are activated (fig. 15).

Fuel and oil

Recommended fuels

Use only a mixture of unleaded petrol and special 2-stroke engine oil. Mix the fuel mixture as indicated in the fuel mixing table.

Important: Do not use a fuel mixture which has been stored for longer than 90 days.

Important: Never use 2-stroke oil with a recommended mixing ratio of 100:1. The manufacturer's warranty will be voided in case of engine damage due to inadequate lubrication.

Important: Only use containers designed and approved for the purpose to transport and store fuel.

Pour the correct quantities of petrol and 2-stroke oil into the mixing bottle (see scale printed on the bottle). Then shake the bottle well.

Never use oil for 4-cycle engine or use water cooled 2-cycle engine. It can cause spark plug fouling exhaust part blocking or piston ring sticking.

Mixed fuels, which have been left unused for a period of one month or more, may clog the carburetor or result in the engine foiling to operate property. Put remained fuel into an airtight container and keep it in the dark and cool room.

Fuel mixing table

Mixing procedure: 40 parts petrol to 1 part oil

Example:

1 L Petrol : 0.025 L 2-stroke oil

5 L Petrol : 0.125 L 2-stroke oil

Warning! Take care of the emission of exhaust gases.

Always shut off engine before fuelling. Never add fuel to a machine with a running or hot engine. Take care of fire!

Only refuel outdoors or in well-ventilated areas. Make sure that no fuel is trapped in the soil (environmental Protection). Use suitable base.

Filling with fuel

Danger of injury! Fuel is explosive!

Turn the motor off and let the machine cool down.

- Wear safety gloves.
- Avoid contact with skin and eyes.
- Make sure you observe the “Safety Instructions” paragraph.
- Only ever refuel the tool outdoors or in sufficiently ventilated rooms.
- Clean around the filling area. Contaminants in the tank will cause operating problems.
- Before refuelling, shake the container with the fuel mixture.
- Carefully pour in the fuel mixture to the lower edge of the filler.
- Close the fuel filler cap. Ensure the fuel filler cap closes tightly.
- Clean the fuel filler cap and the area around it.
- Check the tank and the fuel line for leaks.
- Before starting the motor, remove yourself from the fuelling place by at least three metres.

Draining fuel.

Only ever empty the tank outdoors or in well-ventilated rooms. Make sure not to spill fuel or chain oil into the soil (environmental protection). Use a proper base.

- Hold a collection container beneath the fuel drain bolt.
- Unscrew the tank cap and remove it.
- Allow the fuel to run out completely.
- Screw the tank cap on firmly by hand.

Check before use!

Check the safe condition of the device:

- Check the device for leaks.
- Check the device for visual defects.
- Check that all parts of the device have been securely fitted.
- Check that all safety devices are in proper condition.

Starting the blower vac

- To start the blower vac ensure that the intermediate suction/blower tube is fitted correctly.
- To use the appliance follow the motor starting instructions as described in the operating instructions.
- Make sure that nothing is covering the exhaust pipe as this would cause heat to build up.
- Hold the handle firmly with your right hand and swing the nozzle back and forth so that the desired area is cleared of contamination.
- The throttle control (3) and the engine switch (1) are integrated in the handle.
- With the throttle lockout (2), the engine can be locked at full throttle without constantly pressing the throttle control (3). Caution: Before switching off the device, push the throttle lockout (2) to idle.

PREPARE THE MACHINE

The machine can be used as both a blower and a vacuum collector. For both of these uses it is necessary to correctly arrange the appropriate accessories included with the equipment.

Warning: Unpacking and completing the assembly should be done on a flat and stable surface, with enough space for moving the machine and its packaging, always making use of suitable equipment.

IMPORTANT The safety systems prevent the engine from starting if the vacuum or blower tubes are not assembled correctly.

The engine can not start if you do not assemble the vacuum tube when using as a vacuum.



CHECKING THE MACHINE

Before starting work please:

- Check that all the screws on the machine are tightly fastened.
- When used as a vacuum collector, make sure the bag is fitted correctly and that the zip is closed.
- Check that the air filter is clean.
- Check that the hand grips are well fastened.
- Prepare accessories according to the type of work (as blower or vacuum collector) and make sure they are correctly mounted.
- Fill with fuel as indicated below.

Start (Fig 6)

Once the machine has been set up properly, start the engine as follow:

1. Turn the engine switch(1) to the ON (I) position.
2. Put the choke lever(11) on the  position .
3. Press the fuel pump(10) more than 10 times.
4. Pull the recoil starter handle (8) 3-5 times to start the engine.
5. Once the motor is running, briefly wait, then put the choke lever(11) into position. 
6. If there are problems, immediately turn the engine switch (1) to "0" so the motor stops.
7. If the motor is warm, you can leave the choke lever(11) in the "warm start and work" position. 

Note: If the engine does not start up even after several attempts, read the section „Engine troubleshooting“.

Note: Always pull the starter cord out in a straight line. If it is pulled out at an angle, then friction will occur on the eyelet. As a result of this friction, the cable will become frayed and will wear away faster.

Always hold the starter handle when the cable retracts. Never allow the cable to snap back when it has been pulled out.

Operating modes

Use as a blower

Warning: The machine must always be firmly gripped with your right hand on the upper hand grip during work.

The engine speed should be adjusted to the type of material to be removed:

- Use the engine at low speed for lightweight material on the lawn.
- Use the engine at average speed to move grass and lightweight leaves on pavement or solid ground.
- Use the engine at high speed for heavier materials like fresh snow or voluminous dirt.

Warning: Always pay the utmost attention to prevent removed material or dust from injuring people or animals or damaging property. Always assess the wind direction and never work against the wind.

Use as a vacuum collector

Warning: The machine must always be firmly held with both hands during work. Place your left hand on the upper hand grip and your right hand on the lower hand grip so that the bag is on the right-hand side of the operator.

When used as a vacuum collector, it is best to use the engine at average/high speed. During collection, keep the rounded end of the tube a few centimetres off the ground. The bag also works as a filter similar to a common home vacuum.

For this reason it is best that:

- It is always free to expand and the support strap is not tangled.
- It is not fully filled.
- Collected objects that could jeopardise integrity are promptly removed.

To empty the bag:

- Switch the engine off.
- Open the zipper and empty the bag without disconnecting it from the fitting tube.
- **IMPORTANT** When used as a vacuum collector do not collect damp grass or leaves to avoid clogging the rotor and bag.

IMPORTANT: When using the machine as a vacuum collector, there is a risk of inadvertently suctioning objects which can obstruct the machine and block the rotor.

In this case:

- Switch the motor off immediately - remove the spark plug cap.
- Disassemble the vacuum tube.
- Remove the foreign body from inside the vacuum inlet.
- Check that nothing is blocking the rotor before using the machine again.

IMPORTANT: A too full bag reduces the machine's efficiency and could cause the engine to over heat.

End of operations

When you have finished your work:

- Switch off the engine as indicated above.
- Empty the bag if used as a vacuum collector.
- If the rotor blocks, please follow the instructions as explained above.

Tuning idle speed (Fig. 5)

Idling must be adjusted when the engine tends to turn off or no significant speed differences are noted when using the throttle.

Adjustment is performed after starting the engine and letting it run idle for several minutes, using the screw (D):

- Turn clockwise to increase engine rpm;
- Turn counter-clockwise to decrease engine rpm.

After adjusting, the engine should idle without irregularities or pauses.

Stopping the engine

Emergency Stopping Procedure:

- When it is necessary to stop blower engine immediately, DEPRESS the switch to OFF.

Normal procedure:

- To stop the motor, push back the throttle lever lock, so that the motor runs in idling mode. Finally move the ON/OFF switch to "OFF".

VIII. Working instructions

Operation

- Do not smoke while refuelling or operating equipment.
- Do not touch or let your hands or body come in contact with a hot muffler or spark plug wire.
- Due to the danger of exhaust fumes, never operate blower in a confined or poorly ventilated area.
- Use the tool only in broad daylight or in well-lit conditions.
- Do not underestimate the forces involved. Make sure you stand squarely and keep your balance at all times.
- If possible, avoid using the tool on wet grass.
- Ensure that you maintain a steady foothold particularly while working on slopes.
- Always walk. Never run.
- Always keep the ventilation opening clean.
- Never direct the blow hole at persons or animals.
- The machine may only be used at reasonable times of the day, i.e. not in the early morning or late evening when it will be a nuisance to other people. Permitted times of use specified by local authorities must be observed.
- The machine must be run at the lowest possible motor speed required to carry out the work.
- Remove all foreign objects with a rake and brush before starting any blowing work.
- Where conditions are dusty, dampen the surface a little or use a sprinkler attachment.
- Use the full-length blower nozzle extension so that the air current can work near to the ground.
- Watch out for children, pets, open windows etc. and blow the foreign objects safely away from them.
- If the device makes abnormal noises or has unusually high levels of vibration, it must be checked. Unusually high levels of vibration can injure the operator and damage the unit.
- Never operate the appliance with defective guards or shields, or without safety devices, for example debris collector in place
- Do not expose the hot engine to flammable materials
- The Blower can be used to blow debris from patios, paths, driveways, lawns, bushes and borders.

Blower and vac mode

- Select the blow function using the selector lever on the side of the machine and switch on.
- Alternatively hold nozzle just above the ground and swing the machine from side to side, moving forwards and direct the nozzle at the debris to be cleared.
- Blow the debris into a convenient heap.

IX. Maintenance

Important!

Always pull out the spark boot plug each time before carrying out any cleaning.

Never immerse the equipment in water or other liquids in order to clean it.

Store the petrol multi-garden tool in a safe and dry place out of the reach of children.

Cleaning

- Keep the ventilation slots of the machine clean to prevent overheating of the engine.
- Regularly clean the machine housing with a soft cloth, preferably after each use.
- Keep the ventilation slots free from dust and dirt.
- If the dirt does not come off use a soft cloth moistened with soapy water.
- Regularly check the device before starting work.
- Never use water to clean or spray the device. Clean the motor casing with a damp cloth and never use detergents or solvents! This may damage the device's plastic parts. Dry the motor casing carefully afterwards.
- After shaking out the debris bag, turn it inside out and thoroughly clean it in order to prevent mould and unpleasant odors from forming.
- You can use soap and water to clean out a heavily soiled debris bag.
- Rub a bar of dry soap across the zipper teeth if the zipper becomes difficult to pull.
- Clean the vacuum/blower tube with a brush upon evidence of dirt and grime.
- Dirt and grime can make the switch (blower/vacuum) more difficult to operate as a result of the material that swirls up off the ground. When this occurs, simply flip the switch back and forth a few times, which should bring it back to the normal feel.
- Only use OEM parts for maintenance work. Using parts other than original parts can cause damage to the machine.

Change and clean the spark plug (Fig. 3)

Check the spark plug air gap at least once a year or when the engine starts poorly.

The correct gap between ignition flag and ignition contact is 0.25"/0.63 mm.

- Wait until the engine has cooled down completely.
- Pull the spark plug cap off the spark plug, and use the supplied spark plug wrench to remove the spark plug by turning.
- When the electrode is severely worn out or reveals a strong incrustation, the spark plug must be replaced with an equivalent plug.
- A strong incrustation of the spark plug can be caused by: Amount of oil is too high in the petrol mix, poor oil quality, old petrol mix, or plugged up air filter.
- Screw the spark plug by hand completely into the thread. (Avoid jamming it)
- Use the supplied spark plug wrench to tighten the spark plug.
- When using a torque wrench, the tightening torque is 12-15 Nm.
- Plug the spark plug socket correctly on the plug.

Clean the air filter (Fig. 4)

Soiled air filters reduce the engine power by supplying too little air to the carburetor. Dust and pollen plug up the pores of the filter made of foamed plastic. Regular checks are therefore essential.

- Unclip (A) the air filter cover (B) and remove the sponge filter element (C).
- To avoid objects falling into the air tank, replace the air filter cover.
- Wash the filter element in warm soap water, rinse and allow drying naturally.

Important: Never clean the air filter with petrol or inflammable solvents.

In order not to shorten the service life of the engine, a damaged air filter must be replaced at once.

Warning! Never run the engine without the air filter element installed.

FUEL FILTER

Inside the fuel tank there is a filter which prevents impurities from entering the engine. The filter should be replaced once a year by a qualified service technician.

Our machines have been designed to operate over a long period of time with a minimum of maintenance. Continuous satisfactory operation depends upon proper machine care and regular cleaning.

Keep all nuts, bolts and screws tight to be sure the appliance is in safe working condition.

- Replace worn or damaged parts.
- Use only genuine replacement parts and accessories
- Store the appliance only in a dry place.

The user is responsible for all damages caused by non-compliance with instructions in this manual. This also applies to non-authorized modifications of the tool, use of non-authorized spare parts, accessories, working tools, unrelated and not intended use, secondary damages due to use of faulty components.

Warning!

Use only original manufacturer's replacement parts, accessories and attachments. Failure to do so can cause poor performance, possible injury and may void your warranty.

Important hint in case of sending the equipment to a service station:

Due to security reasons please see to it that the equipment is sent back free of oil and gas!

Ordering replacement parts

Please quote the following data when ordering replacement parts:

- Type of machine
- Article number of the machine

Service information

Please note that the following parts of this product are subject to normal or natural wear and that the following parts are therefore also required for use as consumables.

Wear parts*: Spark plug, Air filter, Fuel filter, Capacity bag

* Not necessarily included in the scope of delivery!

X. Storage

Important: Never put the equipment into storage for longer than 30 days without carrying out the following steps.

Storing the equipment

If you intend to store the equipment for longer than 30 days, the equipment must be prepared accordingly. Otherwise the fuel still remaining in the carburetor will evaporate and leave a rubbery sediment. This can cause problems when starting up the equipment and may require expensive repairs.

- Slowly remove the fuel tank cap to release any pressure that may have formed in the tank. Carefully empty the tank. Empty the tank only outdoors or in well-ventilated areas. Make sure that no fuel enters soil (environmental Protection). Use suitable base.
- To remove the fuel from the carburetor, start the engine and let it run until the equipment stops.
- Leave the engine to cool (approx. 5 minutes).
- Remove the spark plug (see section Change and clean the spark plug).
- Add one teaspoon of 2-stroke engine oil into the combustion chamber. Slowly pull the starter cord several times to apply a layer of oil to all internal components. Fit the spark plug again.

Note: Store the equipment in a dry place and far away from possible ignition sources such as an oven, a gas-fired hot water boiler, a gas-fired dryer, etc.

Putting the equipment back into operation

- Remove the spark plug (see section Change and clean the spark plug).
- Quickly tug on the starter cord to remove excess oil from the combustion chamber.
- Clean the spark plug and check that the electrode gap is correct, or insert a new spark plug with the correct electrode gap.
- Prepare the equipment for operation.

Transport

- Allow the engine to cool down (approx. 5min).
- Empty the capacity bag if necessary.
- Make sure that the Petrol Blower Vacuum is always in an upright position so that no fuel can escape. Secure the unit against tipping over!

XI. Disposal and recycling

The equipment is supplied in packaging to prevent it from being damaged in transit. The raw materials in this packaging can be reused or recycled. The equipment and its accessories are made of various types of material, such as metal and plastic. Defective components must be disposed of as special waste. Ask your dealer or your local council.

XII. Troubleshooting

The table below contains a list of fault symptoms and explains what you can do to remedy the problem if your equipment fails to work properly. If the problem still persists after working through the list, please contact your nearest service workshop.

Important hint in case of sending the equipment to a service station:

Due to security reasons please see to it that the equipment is sent back free of oil and petrol!

Fault	Possible cause	Remedy
Machine does not start.	<ul style="list-style-type: none"> • Air filter is contaminated. • Fuel filter is blocked. • Lack of fuel supply. • Fault in the fuel line. • Starting device is faulty. • Engine stalled. • Spark plug cap not attached. • No spark. • Engine faulty. • Carburetor faulty • Blowing/suction pipe is not completely fitted 	<ul style="list-style-type: none"> • Clean/replace the air filter. • Clean or renew the fuel filter. • Re-fuel. • Check the fuel line for kinks or damage. • Contact the service centre. • Remove the spark plug, clean and dry it; then pull the starter rope several times; re-fix the spark plug. • Check the correct position of the spark plug cap. • Clean the spark plug or replace it, if applicable. Check the ignition cable for damage. • Contact the service centre. • Contact the service centre. • Install a two-part blowing/suction pipe
Machine starts but stops again.	Wrong carburetor setting (idle speed).	Contact the service centre.
Machine works with interruptions (sputtering).	<ul style="list-style-type: none"> • Carburetor set up incorrectly. • Spark plug is sooty. • On/off switch faulty. 	<ul style="list-style-type: none"> • Contact the service centre. • Clean the spark plug or replace it. • Contact the service centre.
Smoke is generated	<ul style="list-style-type: none"> • Wrong fuel mix. • Carburetor set up incorrectly. 	<ul style="list-style-type: none"> • Use two-stroke mixture at a ratio of 40:1. • Contact the service centre.

<p>Machine does not work at full power.</p>	<ul style="list-style-type: none"> • Air filter is contaminated. • Carburetor set up incorrectly. • Capacity bag is full • Capacity bag is dirty • Selector switch in incorrect position • Device clogged up or blocked by foreign bodies 	<ul style="list-style-type: none"> • Clean the air filter or replace it. • Contact the service centre. • Check the exhaust. • Empty capacity bag • Clean capacity bag • Set selector switch to the suction symbol • Remove plug or blockages (see chapter Cleaning and Maintenance)
---	---	--



FERREX[®]

Petrol Blower Vacuum



Warranty Details

REGISTER YOUR PURCHASE AT www.aldi.com.au/en/about-aldi/product-registration/ TO KEEP UP-TO-DATE WITH IMPORTANT PRODUCT INFORMATION

The product is guaranteed to be free from defects in workmanship and parts for a period of 12 months from the date of purchase. Defects that occur within this warranty period, under normal use and care, will be repaired, replaced or refunded at our discretion. The benefits conferred by this warranty are in addition to all rights and remedies in respect of the product that the consumer has under the Competition and Consumer Act 2010 and similar state and territory laws.

Our goods come with guarantees that cannot be excluded under the Australian Consumer Law. You are entitled to a replacement or refund for a major failure and for compensation for any other reasonably foreseeable loss or damage. You are also entitled to have the goods repaired or replaced if the goods fail to be of acceptable quality and the failure does not amount to a major failure.

AFTER SALES SUPPORT

  1300 855 831

AUS Hotline Costs: Local rate for landline calls*
*Charges may vary dependent upon network operator or mobile network provider.

 support@schepach.com.au

MODEL: LBH2600P PRODUCT CODE: 706300 10/2021





Repair and Refurbished Goods or Parts Notice

Unfortunately, from time to time, faulty products are manufactured which need to be returned to the Supplier for repair.

Please be aware that if your product is capable of retaining user-generated data (such as files stored on a computer hard drive, telephone numbers stored on a mobile telephone, songs stored on a portable media player, games saved on a games console or files stored on a USB memory stick) during the process of repair, some or all of your stored data may be lost.

We recommend you save this data elsewhere prior to sending the product for repair.

You should also be aware that rather than repairing goods, we may replace them with refurbished goods of the same type or use refurbished parts in the repair process.

Please be assured though, refurbished parts or replacements are only used where they meet ALDI's stringent quality specifications.

If at any time you feel your repair is being handled unsatisfactorily, you may escalate your complaint. Please telephone us on SUPPLIER TELEPHONE or write to us at:



RossMac Pty. Ltd.

P.O. Box 261, Essendon North, Victoria, 3041

Telephone: 1300 855 831 (Monday - Friday 8:00am-6:00pm)

Email: support@schepach.com.au

AFTER SALES SUPPORT

  1300 855 831

 support@schepach.com.au

AUS Hotline Costs: Local rate for landline calls*
*Charges may vary dependent upon network operator or mobile network provider.

MODEL: LBH2600P PRODUCT CODE: 706300 10/2021



