

# User Manual

## Contents

Overview .....	3
Package contents/part list .....	6
Explanation of Symbols .....	7
Introduction .....	8
Layout .....	9
Scope of delivery.....	9
Intended use .....	10
Safety regulations.....	11
Assembly .....	15
Operation.....	16
Working instructions.....	17
Cleaning and maintenance.....	19
Technical data .....	20
Storage and transport .....	21
Disposal and recycling .....	21
Troubleshooting.....	22
Warranty Details.....	24
Repair and Refurbished Goods or Parts Notice .....	26

# FERREX®

## BENCH GRINDER



ALDI guarantees that our exclusive brand products are developed to our stringent quality specifications. If you are not entirely satisfied with this product, please return it to the nearest ALDI store within 60 days from the date of purchase, for a full refund or replacement, or take advantage of our after sales support by calling the supplier's Customer Service Hotline.



### Made in China

FERREX® is a registered trademark of ALDI Stores

DISTRIBUTED BY:

ALDI STORES  
1 SARGENTS ROAD  
MINCHINBURY NSW 2770  
www.aldi.com.au

AFTER SALES SUPPORT

705990

1300 855 831

support@scheppach.com.au

MODEL:  
FBGS240E1

08/2022

**3**  
YEAR  
WARRANTY

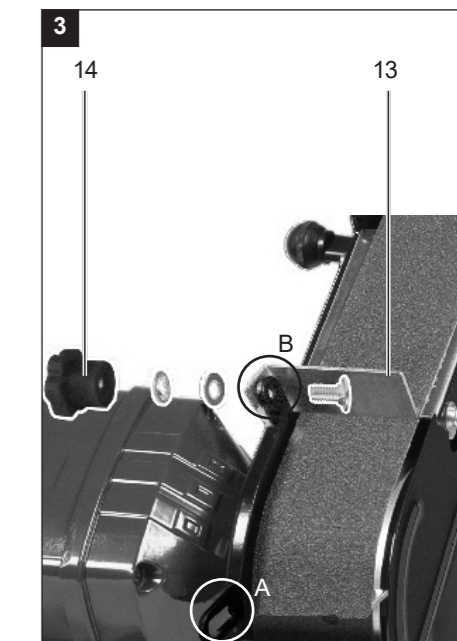
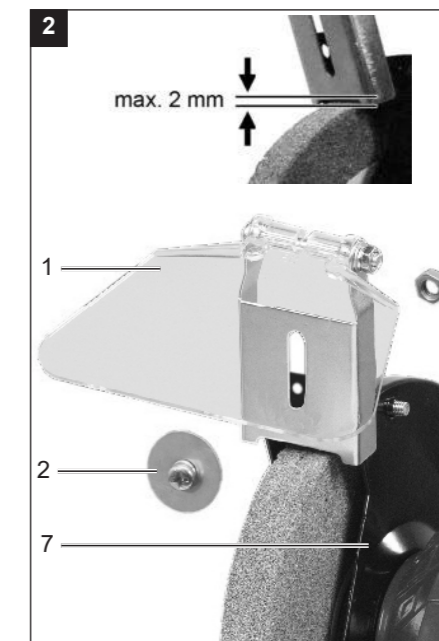
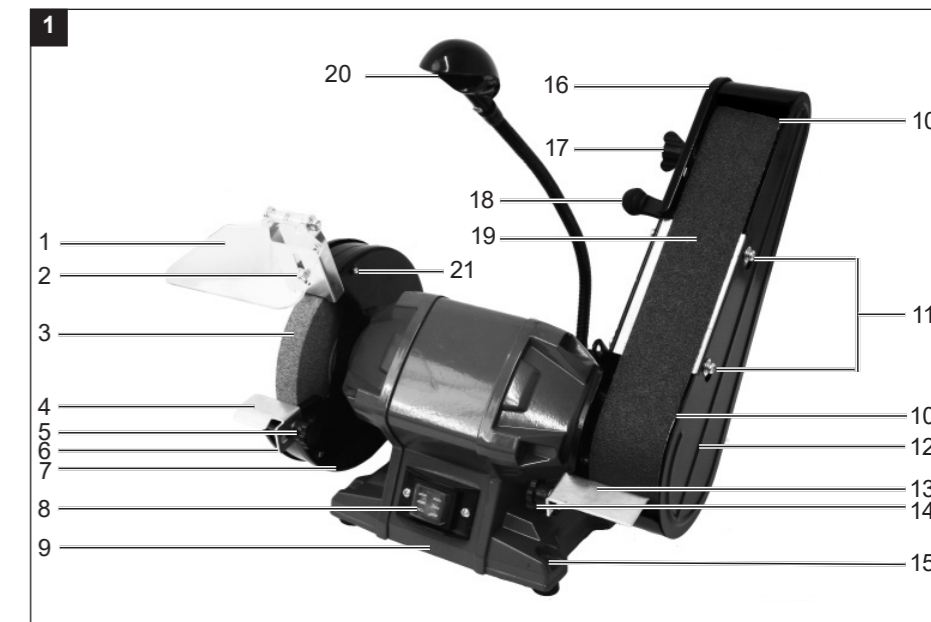

Dok./Rev.-Nr. 705990\_20220210

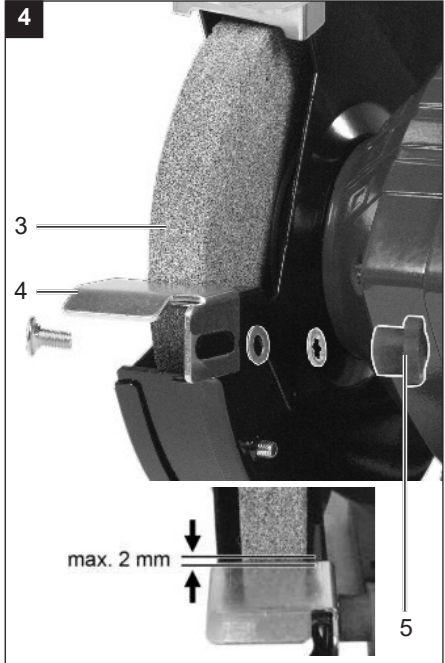





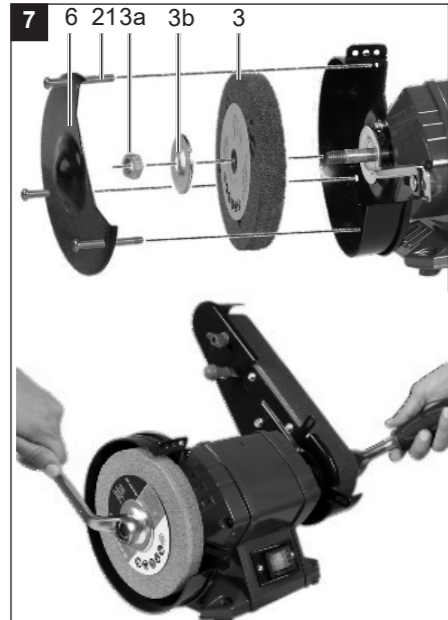
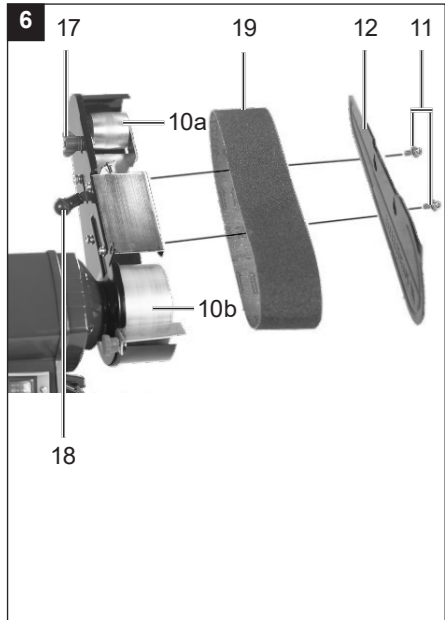
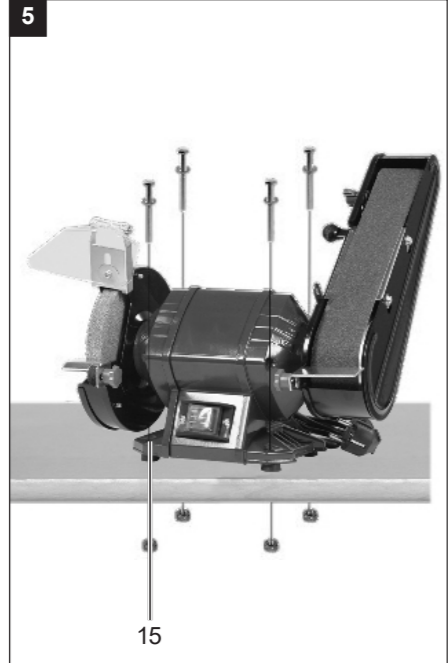





**Package contents/part list**

- 1 Bench Grinder, 1x
- 2 Spark protection, 1x
- 3 Adjusting screw for spark protection, 1x
- 4 Workpiece support, 2x
- 5 Sanding belt, 3x
- 6 Warranty card
- 7 Instruction manual



## Explanation of Symbols

The use of symbols in this manual is intended to draw your attention to possible risks. The safety symbols and the explanations that accompany them must be perfectly understood. The warnings in themselves do not remove the risks and cannot replace correct actions for preventing accidents.

	Warning: Read the operating instructions to reduce the risk of injury
	Wear ear-muffs. The impact of noise can cause damage to hearing.
	Wear a breathing mask. Dust which is injurious to health can be generated when working on wood and other materials. Never use the device to work on any materials containing asbestos!
	Wear safety goggles. Sparks generated during working or splinters, chips and dust emitted by the device can cause loss of sight.
	Wear protective gloves.
	Never use faulty grinding disks.
	Caution! Risk of electric shock!
 Made in China	Complies with the Australian norms and standards.
	Warranty period.
	Warranty class.

## Introduction

Congratulations on choosing to buy a FERREX® product.

All products brought to you by FERREX® are manufactured to the highest standards of performance and safety, and as part of our philosophy of customer service and satisfaction, are backed by our comprehensive 3 Years Warranty.

We hope you will enjoy using your purchase for many years to come.

### **Note:**

According to the applicable product liability law the manufacturer of this device is not liable for damages which arise on or in connection with this device in case of:

- improper handling,
- non-compliance with the instructions for use,
- repairs by third party, non-authorized skilled workers,
- installation and replacement of non-original spare parts,
- improper use.

### **Recommendations:**

Read the entire text of the operating instructions prior to the assembly and operation of the device.

These operating instructions are intended to make it easier for you to get familiar with your device and utilise its intended possibilities of use.

The operating instructions contain important notes on how to work safely, properly and economically with your machine and how to avoid dangers, save repair costs, reduce downtime, and increase the reliability and working life of the machine.

In addition to the safety regulations contained herein, you must in any case comply with the applicable regulations of your country with respect to the operation of the machine.

Keep the operating instructions in a clear plastic folder to protect them from dirt and humidity; store them near the machine. The instructions should be read and carefully understood by each operator prior to using the machine. Only persons who have been trained in the use of the machine and are aware of the related dangers and risks should be allowed to use the machine. The local required minimum age must be met.

In addition to the safety notes contained in these operating instructions and any specific regulations in your country, the generally recognised technical rules for the operation of identically constructed machines must be observed.

## Layout (Fig. 1)

1. Spark protection
2. Adjusting screw for spark protection
3. Grinding disc
4. Workpiece support grinding disc
5. Star grip nut to mount/adjust the workpiece support grinding disc
6. Grinding disc cover
7. Protective hood grinding disc
8. On/Off switch
9. Engine housing
10. Upper (a) and lower (b) roller
11. Fixing screws for grinding disc cover
12. Grinding disc cover
13. Workpiece support grinding belt
14. Star grip nut to install the workpiece support grinding belt
15. Bore holes for table mounting
16. Protective hood grinding belt
17. Adjusting screw for belt run
18. Clamping lever grinding belt
19. Grinding belt
20. Working light
21. Fixing screws for grinding disc cover

## Scope of delivery

Bench Grinder	1x
Spark protection	1x
Adjusting screw for spark protection	1x
Workpiece support	2x
Sanding belt (1x grit 80 pre-mounted, 1x grit 80, 1x grit 120)	3x
Warranty card	1x
Instruction manual	1x

- Open the packaging and take out the equipment with care.
- Remove the packaging material.
- Check that all listed contents are present.
- Inspect the equipment and parts for any damage. Please contact the helpline if anything is missing.
- If possible, keep the packaging until the end of the guarantee period.
- Read the operating instructions fully to familiarise yourself with the tool prior to using it.
- Only use original accessories and spare parts. Spare parts are available by contacting the helpline.
- Specify the part numbers when you contact the helpline.

**⚠ ATTENTION!**

**The device and packaging materials are not toys!**

**Children must not be allowed to play with plastic bags, film and small parts!**

**There is a risk of swallowing and suffocation!**

## Intended use

The bench grinder with belt sander is a stationary grinding device for the coarse and fine grinding of metal, wood and plastic. It is suitable for deburring, rust removal and grinding.

The device is not intended for all other types of applications (e.g. grinding with unsuitable grinding tools, grinding with a coolant solution, grinding hazardous materials such as asbestos).

The equipment is allowed to be used only for its prescribed purpose. Any other use is deemed to be a case of misuse. The user/operator and not the manufacturer will be liable for any damage or injuries of any kind resulting from such misuse.

An element of the intended use is also the observance of the safety instructions, as well as the assembly instructions and operating information in the operating manual.

Persons who operate and maintain the product must be familiar with the manual and must be informed about potential dangers.

In addition, the applicable accident prevention regulations must be strictly observed. Other general occupational health and safety-related rules and regulations must be observed.

The liability of the manufacturer and resulting damages are excluded in the event of modifications of the machine.

---

The machine may only be operated with original parts and original accessories from the manufacturer.

The safety, operating and maintenance specifications of the manufacturer, as well as the dimensions specified in the operating manual, must be observed.

This equipment is intended for domestic DIY use only. We assume no guarantee if the product is used in commercial or industrial applications, or for equivalent work.

## Safety regulations

### General power tool safety warnings

**⚠ WARNING Read all safety warnings, instructions, illustrations and specifications provided with this power tool.** Failure to follow all instructions listed below may result in electric shock, fire and/or serious injury.

### Save all warnings and instructions for future reference.

The term “power tool” in the warnings refers to your mains-operated (corded) power tool or battery-operated (cordless) power tool.

### 1) Work area safety

- a) **Keep work area clean and well lit.** Cluttered or dark areas invite accidents.
- b) **Do not operate power tools in explosive atmospheres, such as in the presence of flammable liquids, gases or dust.** Power tools create sparks which may ignite the dust or fumes.
- c) **Keep children and bystanders away while operating a power tool.** Distractions can cause you to lose control.

### 2) Electrical safety

- a) **Power tool plugs must match the outlet. Never modify the plug in any way. Do not use any adapter plugs with earthed (grounded) power tools.** Unmodified plugs and matching outlets will reduce risk of electric shock.

- b) Avoid body contact with earthed or grounded surfaces, such as pipes, radiators, ranges and refrigerators.** There is an increased risk of electric shock if your body is earthed or grounded.
- c) Do not expose power tools to rain or wet conditions.** Water entering a power tool will increase the risk of electric shock.
- d) Do not abuse the cord. Never use the cord for carrying, pulling or unplugging the power tool. Keep cord away from heat, oil, sharp edges or moving parts.** Damaged or entangled cords increase the risk of electric shock.
- e) When operating a power tool outdoors, use an extension cord suitable for outdoor use.** Use of a cord suitable for outdoor use reduces the risk of electric shock.
- f) If operating a power tool in a damp location is unavoidable, use a residual current device (RCD) protected supply.** Use of an RCD reduces the risk of electric shock.

### 3) Personal safety

- a) Stay alert, watch what you are doing and use common sense when operating a power tool. Do not use a power tool while you are tired or under the influence of drugs, alcohol or medication.** A moment of inattention while operating power tools may result in serious personal injury.
- b) Use personal protective equipment. Always wear eye protection.** Protective equipment such as a dust mask, non-skid safety shoes, hard hat or hearing protection used for appropriate conditions will reduce personal injuries.
- c) Prevent unintentional starting. Ensure the switch is in the off-position before connecting to power source and/or battery pack, picking up or carrying the tool.** Carrying power tools with your finger on the switch or energising power tools that have the switch on invites accidents.
- d) Remove any adjusting key or wrench before turning the power tool on.** A wrench or a key left attached to a rotating part of the power tool may result in personal injury.



- e) **Do not overreach. Keep proper footing and balance at all times.** This enables better control of the power tool in unexpected situations.
- f) **Dress properly. Do not wear loose clothing or jewellery. Keep your hair and clothing away from moving parts.** Loose clothes, jewellery or long hair can be caught in moving parts.
- g) **If devices are provided for the connection of dust extraction and collection facilities, ensure these are connected and properly used.** Use of dust collection can reduce dust-related hazards.
- h) **Do not let familiarity gained from frequent use of tools allow you to become complacent and ignore tool safety principles.** A care-less action can cause severe injury within a fraction of a second.

#### 4) Power tool use and care

- a) **Do not force the power tool. Use the correct power tool for your application.** The correct power tool will do the job better and safer at the rate for which it was designed.
- b) **Do not use the power tool if the switch does not turn it on and off.** Any power tool that cannot be controlled with the switch is dangerous and must be repaired.
- c) **Disconnect the plug from the power source and/or remove the battery pack, if detachable, from the power tool before making any adjustments, changing accessories, or storing power tools.** Such preventive safety measures reduce the risk of starting the power tool accidentally.
- d) **Store idle power tools out of the reach of children and do not allow persons unfamiliar with the power tool or these instructions to operate the power tool.** Power tools are dangerous in the hands of untrained users.
- e) **Maintain power tools and accessories. Check for misalignment or binding of moving parts, breakage of parts and any other condition that may affect the power tool's operation. If damaged, have the power tool repaired before use.** Many accidents are caused by poorly maintained power tools.
- f) **Keep cutting tools sharp and clean. Properly maintained cutting tools with sharp cutting edges are less likely to bind and are easier to control.**

- g) Use the power tool, accessories and tool bits etc. in accordance with these instructions, taking into account the working conditions and the work to be performed.** Use of the power tool for operations different from those intended could result in a hazardous situation.
- h) Keep handles and grasping surfaces dry, clean and free from oil and grease.** Slippery handles and grasping surfaces do not allow for safe handling and control of the tool in unexpected situations.

## 5) Service

- a) Have your power tool serviced by a qualified repair person using only identical replacement parts.** This will ensure that the safety of the power tool is maintained.

### Safety instructions for grinding machines

- a) Do not use damaged accessories. Check the accessories, e.g. the grinding disc for cracks before each use. After inspection and installation of an accessory, remove yourself and bystanders from the machine and allow the electric tool to run at maximum idle speed for one minute.** Damaged accessories normally break during this test period.
- b) The nominal speed of the accessories must be at least equal to the maximum speed indicated on the electric tool.** Accessories that run faster than the nominal speed may break.
- c) Never grind on the sides of a grinding disc.** Lateral grinding can cause the grindstone to break.

### Residual Risks

⚠ The machine has been built according to the state of the art and the recognised technical safety requirements. However, individual residual risks can arise during operation.

- Risk of injury for fingers and hands due to the rotating grinding tool.
- Hazard due to electrical power, with the use of improper electrical connection cables.
- Furthermore, despite all precautions having been met, some non-obvious residual risks may still remain.
- Residual risks can be minimised if the “safety instructions” and the “intended use” are observed along with operating manual in its entirety.

# Assembly

## **⚠ WARNING**

**Always pull out the mains plug before carrying out adjustments on the device.**

### **Spark protection assemble/set (Fig. 2)**

- Screw the spark protection (1) using the adjusting screw (2) and the nut on to the protective hood (7). To do so you will need a screwdriver and a ring spanner (AF 8 mm / not included), used to hold it in place.
- Set the spark protection (1) with the adjusting screw (2) so that the distance between the grinding disc (3) and the spark protection is max. 2 mm (see small image).

## **⚠ ATTENTION**

**Periodically readjust the spark protection in order to offset the wear and tear of the grinding disc and the spark protection is max. 2 mm.**

### **Workpiece supports assemble / set (Fig. 3+4)**

- Screw the workpiece supports (4/13) on to the device. Two positions are possible for the tape loop (see fig. 3 / Pos. A + B).
- To do so, use the screws (5/14), washers, toothed lock washer and star grip nuts provided.
- Set the workpiece support of the grinding belt (4) with the star grip nut (5) so that the distance between the grinding disc (3) and the workpiece support is max. 2 mm (see small image).

## **⚠ ATTENTION**

**Periodically readjust the spark protection in order to offset the wear and tear of the grinding disc and the spark protection is max. 2mm.**

### **Screw device on to workbench (Fig. 5)**

- Screw the device onto the workbench with 4 screws and nuts. Insert the screws through the 4 bore holes (15) on the base of the device. The screws and nuts required for assembly are not part of the scope of delivery.

# Operation

## **⚠ ATTENTION**

- Always make sure the device is fully assembled before commissioning!
- Always disconnect the plug from the mains socket before working.
- Use only grinding disks and accessories recommended by the manufacturer. The use of other insertion tools and other accessories may cause risk of injury.
- Only use grinding tools which bear information about the manufacturer, type of binding, dimension and permitted number of revolutions.
- Only use grinding discs where the printed rotational speed is at least as high as what has been specified on the name plate of the device.
- Do not use broken, cracked or other-wise damaged grinding disks.
- Never operate the device without the visual protection disk.
- Always use protective goggles even if you are protected against sparks.
- Always inspect the grinding disc before starting the device: Check the distance between the spark protection and grinding disc as well as workpiece support and grinding disc (distance maximum 2 mm).
- The grinding disc must be replaced once the spark protection and workpiece support on the grinding disc do not have distance of max. 2 mm.
- Switch on the equipment only when it is safely installed on the work surface.

## **⚠ ATTENTION**

**Keep your hands away from the grinding disc and grinding belt when the device is in operation. Injury hazard!**

**⚠ ATTENTION! It is recommended that the tool always be supplied via a residual current device having a rated residual current of 30mA or less.**

## **Switching on and off**

- To switch on, press the “I” on switch (8) and the device starts up and the working light begins to shine.
- To switch off, press the “0” off switch (8) and the device switches off and the working light goes out as a result.

After switching on the device, wait until the device has reached its max. speed. Only then must you start the grinding.

---

**⚠ ATTENTION**

**The disk will continue to run after the equipment is switched off. There is a risk of injury.**

**Test run:**

Before starting work and after each change of grinding disk, carry out a test run of at least 60 seconds with no load. Switch off the equipment immediately if the disc runs lumpy, substantial vibrations occur, or abnormal noises are generated.

## Working instructions

### Grinding with the grinding disc

**⚠ ATTENTION**

**Fold down the spark protection (1) when grinding in order to avoid injury from sparks.**

NOTE: The arrow on the protective hood (7) shows the direction of rotation of the grinding disc.

- Place the workpiece on the workpiece support (4) and slowly bring it to its desired angle on the grinding disc (3).
- Move the workpiece slightly from side to side in order to achieve an optimal grinding result. This way, the grinding disc is worn uniformly. Occasionally, allow the workpiece to cool down.

### Tape loops

NOTE: The arrow on the protective hood (16) shows the direction of rotation of the grinding belt.

- Firmly hold the workpiece, do not exert any strong force.
- Move the workpiece slightly from side to side in order to avoid a one-sided wear of the grinding belt.
- Always grind the pieces of wood in the direction of the wood grain in order to avoid chipping.

### Change grinding belt (Fig. 6)

- Loosen the 2 fixing screws (11) and hang out the grinding belt cover (12).
- Press the clamping lever (18) downwards and detract the grinding belt (19).
- Place the new grinding belt (19) in the centre on the upper (10a) and lower (10b) rollers.
- Push the clamping lever grinding belt (18) and mount the grinding belt cover (12).

## Set the tape run

- The tape run accuracy is set by turning the adjusting screw for belt run (12).
- Check the tape run by manually turning the grinding belt.

## Change grinding disc (Fig. 7)

### Information on replacement:

- Never operate the device without protective equipment.
- Ensure that the rotation speed stated on the grinding disc (3) is the same or higher than the nominal rotation speed of the device.
- Ensure that the grinding disc dimensions match those of the device.
- Only use flawless grinding discs (ringing test: when you strike the grinding disc with a plastic hammer, it results in a clear sound).
- Never re-drill a locating hole which is too small to make it larger.
- Never use separate bushings or adapters in order to make grinding discs whose hole is too large fit the device.
- Do not use any saw blades.
- To clamp the grinding tools only use the clamping flange provided. The pads between the clamping flange and the grinding tools must be made of elastic materials e.g., rubber, soft cardboard etc.
- Always reassemble the device completely after replacing the grinding disc.

### **⚠ ATTENTION**

**Switch the device off and remove the mains plug. Allow the device to cool down. Wear protective gloves when changing the grinding discs in order to avoid cutting risk.**

- Remove the spark protection (1) (see “Assemble/set spark protection”).
- Loosen the 3 fixing screws (21) and remove the grinding disc cover (6).
- Loosen the fixing screws (11) and remove the grinding belt cover (12) (see “Changing the grinding belt”).
- Unscrew the grinding disc nut (3a) in the clockwise direction, by holding the nut of the opposite roller of the grinding belt in place (see small image). Hold it tight with a 19mm socket wrench or pliers (not included).
- Remove the clamping flange (3b) and the grinding disc (3).
- Set up the new grinding disc (3) and the clamping flange and manually screw the grinding disc nut (3a) in the anti-clockwise direction.
- Screw the grinding disc cover (6).
- Set the spark protection (1) and the workpiece support (4) so that the distance between the grinding disc (3) is max. 2 mm (see “Assembly”)

The grinding disc nut must not be screwed too tightly in order to avoid a breaking of the grinding disc and nut.

### **Test run:**

Before starting work and after each change of grinding disk, carry out a test run of at least 60 seconds with no load. Switch off the equipment immediately if the disk runs lumpy, substation vibrations occur, or abnormal noises are generated.

## **Cleaning and maintenance**

Always pull out the mains power plug before starting any cleaning work.

Have any work not described in these instructions carried out by a specialist workshop. Use only original components. Allow the equipment to cool before carrying out any maintenance and cleaning work. There is a risk of burns.

Before each use, check the equipment for obvious defects such as loose, worn or damaged components and check that screws or other parts are sitting correctly. In particular, check the grinding disk (3). Replace damaged parts.

### **Cleaning**

- Keep all safety devices, air vents and the motor housing free of dirt and dust as far as possible. Wipe the equipment with a clean cloth or blow it with compressed air at low pressure.
- We recommend that you clean the device immediately each time you have finished using it.
- Clean the equipment regularly with a moist cloth and some soft soap. Do not use cleaning agents or solvents; these could attack the plastic parts of the equipment. Ensure that no water can seep into the device.

### **Maintenance**

The device is maintenance-free.

**Attention! If the replacement of the supply cord is necessary, this has to be done by the manufacturer or his agent in order to avoid hazards.**

 **Caution, risk of electric shock!** The light source in this luminaire shall only be replaced by the manufacturer or his service agent or a similar qualified person.

### Service information

Please note that the following parts of this product are subject to normal or natural wear and that the following parts are therefore also required for use as consumables.

Wear parts\*: Grinding disc, grinding belt.

\* Not necessarily included in the scope of delivery!

## Technical data

Rated voltage	230-240 V~
Rated input	240 W
Protection class	I
Protection category:	IPX0
Idling speed	2980 min <sup>-1</sup>
Grinding disc dimension	Ø150 x 20 x 12.7 mm
Grinding disc granulation	36
Grinding disc velocity	35 m/s
Grinding belt dimension	686 x 50 mm
Grinding belt granulation	80 / 120
Grinding belt velocity	15 m/s
Weight	7 kg

### Noise

Sound and vibration values were measured in accordance with EN 62841.

Sound pressure level $L_{pA}$	86.6 dB(A)
Uncertainty $K_{pA}$	3 dB
Sound power level $L_{WA}$	99.6 dB(A)
Uncertainty $K_{WA}$	3 dB



### **Wear ear-muffs.**

Excessive noise can result in a loss of hearing.

The above-mentioned noise emission values were measured in accordance with a standardised test procedure and can be used to compare one power tool with another.

The specified device emissions values can also be used for an initial estimation of the load.

### **Warning:**

- The noise emission values can vary from the specified values during the actual use of the electric tool, depending on the type and the manner in which the electric tool is used, and in particular the type of workpiece being processed.
- Try to keep the stress as low as possible. For example: Limit working time. In doing so, all parts of the operating cycle must be taken into account (such as times in which the electric tool is switched off or times in which it is switched on, but is not running under a load).

## **Storage and transport**

Store the equipment and accessories out of children's reach in a dark and dry place at above freezing temperature. The ideal storage temperature is between 5 and 30 °C. Store the electric tool in its original packaging.

Grinding disks must be stored dry and upright and are not to be stacked.

### **⚠ ATTENTION Unplug the machine!**

The appliance must unconditionally be secured against falling or turning down during transport.

The appliance can be lifted on the frame.

## **Disposal and recycling**

The equipment is supplied in packaging to prevent it from being damaged in transit. The raw materials in this packaging can be reused or recycled. The equipment and its accessories are made of various types of material, such as metal and plastic. Never place defective equipment in your household refuse. The equipment should be taken to a suitable collection center for proper disposal. If you do not know the whereabouts of such a collection point, you should ask in your local council offices.

## Troubleshooting

The table below contains a list of fault symptoms and explains what you can do to remedy the problem if your equipment fails to work properly. If the problem still persists after working through the list, please contact your nearest service workshop.

### ⚠ **IMPORTANT!**

Hint in case of sending the equipment to a service centre:

Problem	Possible cause	Action
Device doesn't start	Mains voltage missing Main circuit breaker is tripped	Check the socket, mains cable, line, mains plug, repairs to be carried out by qualified electrician if necessary, check main circuit breaker.
	On/off switch may be defective	Repair by Customer Care
	Engine faulty	
Grinding tools do not move although the engine is running	Grinding disc nut loose	Tighten grinding disc nut (see "Changing the grinding disc")
	Grinding belt loose	Re-mount grinding belt (see "Changing the grinding belt")
Drive is blocked	Grinding belt blocking drive	Re-mount grinding belt (see "Changing the grinding belt")
	Workpiece, remaining workpieces or remaining grinding tools block drive	Remove blockages
Engine is slower and stops	Device is overloaded through workpiece	Reduce pressure on grinding tool
		Workpiece unsuitable
Grinding disc does not rotate smoothly, abnormal noises can be heard	Grinding disc nut loose	Tighten grinding disc nut (see "Changing the grinding disc")
	Grinding disc faulty	Change grinding disc
	Spark protection or work-piece support set incorrectly	Set spark protection or work-piece support (see "Assembly")
Bad grinding output	Grinding belt worn	Change grinding belt

---

---



# FERREX®

BENCH GRINDER

## Warranty Details

---

REGISTER YOUR PURCHASE AT [www.aldi.com.au/en/about-aldi/product-registration/](http://www.aldi.com.au/en/about-aldi/product-registration/)  
TO KEEP UP-TO-DATE WITH IMPORTANT PRODUCT INFORMATION

---

The product is guaranteed to be free from defects in workmanship and parts for a period of 36 months from the date of purchase. Defects that occur within this warranty period, under normal use and care, will be repaired, replaced or refunded at our discretion. The benefits conferred by this warranty are in addition to all rights and remedies in respect of the product that the consumer has under the Competition and Consumer Act 2010 and similar state and territory laws.

Our goods come with guarantees that cannot be excluded under the Australian Consumer Law. You are entitled to a replacement or refund for a major failure and for compensation for any other reasonably foreseeable loss or damage. You are also entitled to have the goods repaired or replaced if the goods fail to be of acceptable quality and the failure does not amount to a major failure.

---

#### AFTER SALES SUPPORT

 1300 855 831

 [support@scheppach.com.au](mailto:support@scheppach.com.au)

AU Hotline Costs: Local rate for landline calls\*

\*Charges may vary dependent upon network operator or mobile network provider.







# FERREX®

## BENCH GRINDER

# Repair and Refurbished Goods or Parts Notice

---

REGISTER YOUR PURCHASE AT [www.aldi.com.au/en/about-aldi/product-registration/](http://www.aldi.com.au/en/about-aldi/product-registration/)  
TO KEEP UP-TO-DATE WITH IMPORTANT PRODUCT INFORMATION

---

Unfortunately, from time to time, faulty products are manufactured which need to be returned to the Supplier for repair.

Please be aware that if your product is capable of retaining user-generated data (such as files stored on a computer hard drive, telephone numbers stored on a mobile telephone, songs stored on a portable media player, games saved on a games console or files stored on a USB memory stick) during the process of repair, some or all of your stored data may be lost.

**We recommend you save this data elsewhere prior to sending the product for repair.**

You should also be aware that rather than repairing goods, we may replace them with refurbished goods of the same type or use refurbished parts in the repair process.

**Please be assured though, refurbished parts or replacements are only used where they meet ALDI's stringent quality specifications.**

If at any time you feel your repair is being handled unsatisfactorily, you may escalate your complaint. Please telephone us on "1300 855 831" or write to us at:

RossMac Pty. Ltd.

P.O. Box 261, Essendon North, Victoria, 3041

Telephone: 1300 855 831 (Monday - Friday 8:30am-6:00pm)

Email: [support@schepach.com.au](mailto:support@schepach.com.au)

---

#### AFTER SALES SUPPORT

 1300 855 831

 [support@schepach.com.au](mailto:support@schepach.com.au)

AU Hotline Costs: Local rate for landline calls\*

\*Charges may vary dependent upon network operator or mobile network provider.

