

ALDI guarantees that our exclusive brand products are developed to our stringent quality specifications. If you are not entirely satisfied with this product, please return it to the nearest ALDI store within 60 days from the date of purchase, for a full refund or replacement, or take advantage of our after sales support by calling the supplier's Customer Service Hotline.



Made in China

FERREX® is a registered trademark of ALDI Stores

DISTRIBUTED BY:

ALDI STORES

1 SARGENTS ROAD

MINCHINBURY NSW 2770

www.aldi.com.au

AFTER SALES SUPPORT

10699



1300 855 831



support@scheppach.com.au

MODEL:
BTS920

05/2021

5

**YEAR
WARRANTY**

User Manual

FERREX[®]

BELT & DISC SANDER 450W BTS920



Contents

Overview	3
Package contents/part list	6
Explanation of Symbols	7
Introduction	9
Layout	10
Scope of delivery	10
Intended use	10
Safety regulations.....	11
Assembly	16
Operation.....	17
After Use	20
Technical data	21
Storage and transport	22
Electrical connection.....	22
Disposal and recycling	23
Troubleshooting.....	24
Warranty Details.....	25
Repair and Refurbished Goods or Parts Notice	26

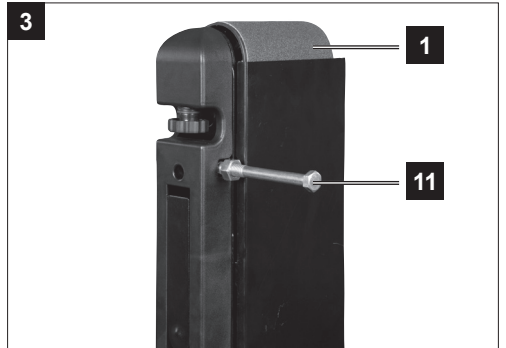
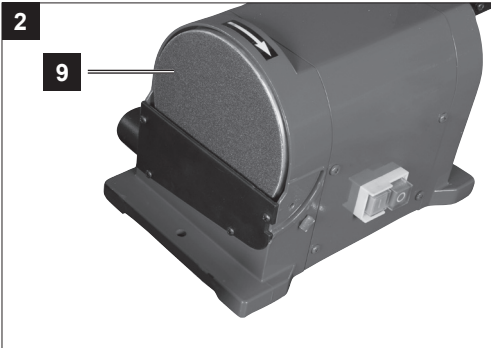
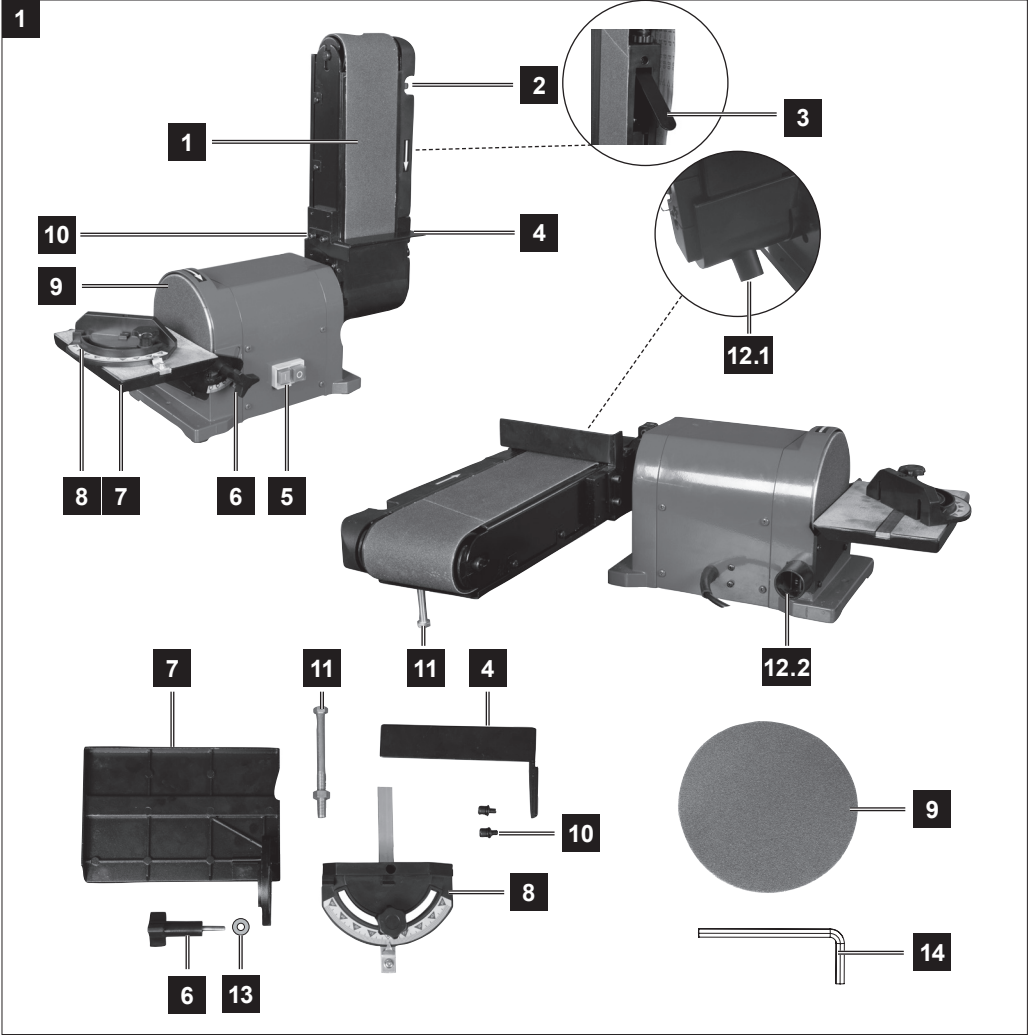

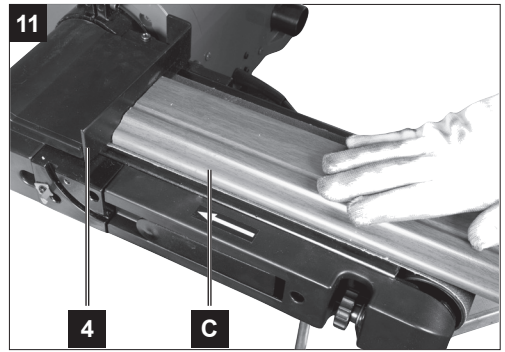
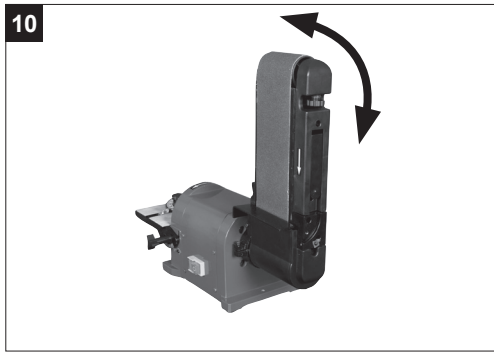
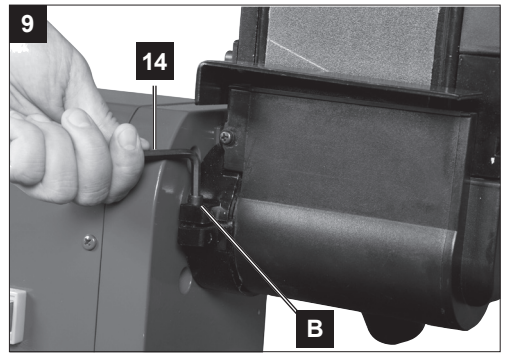
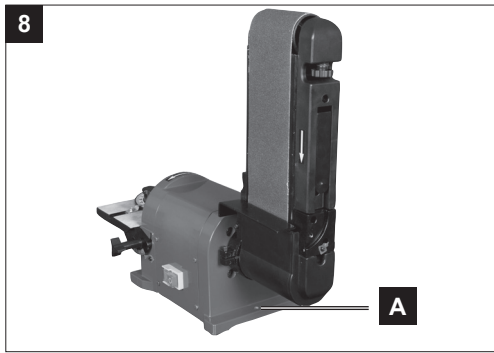
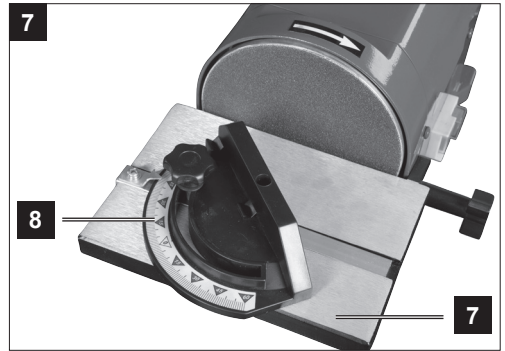
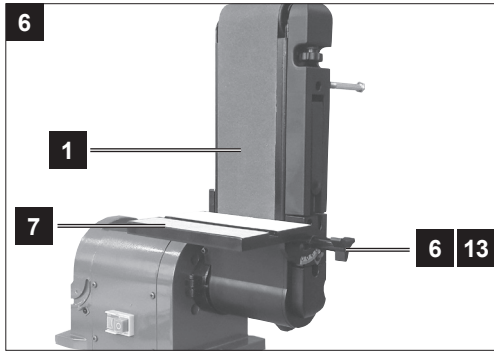
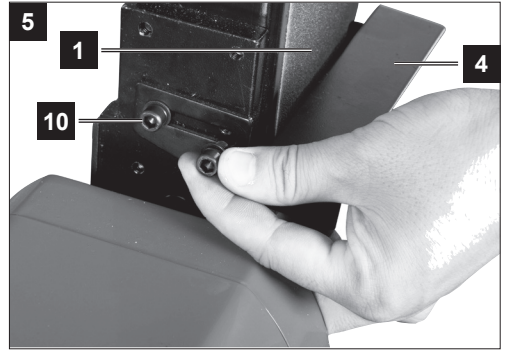
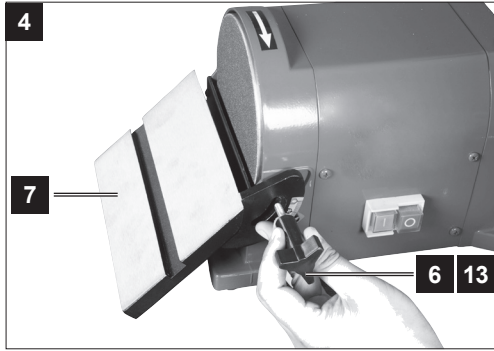

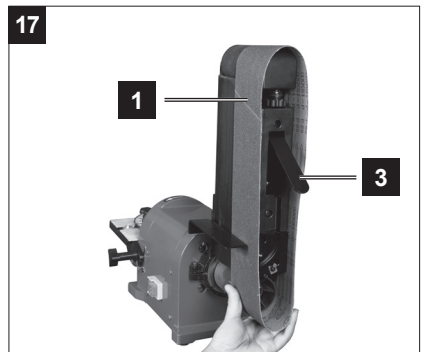
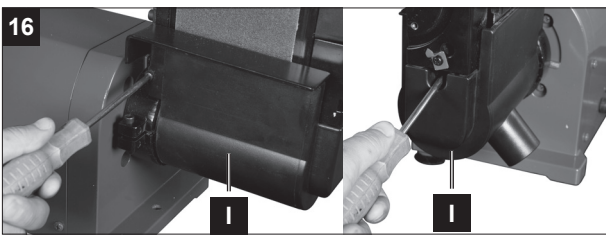
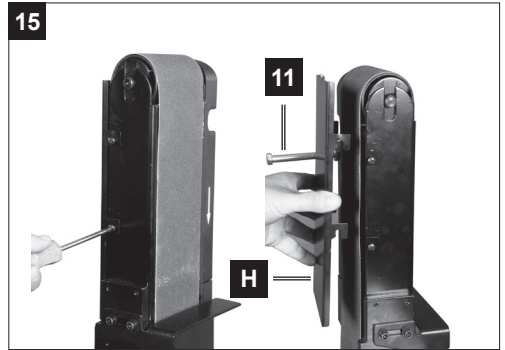
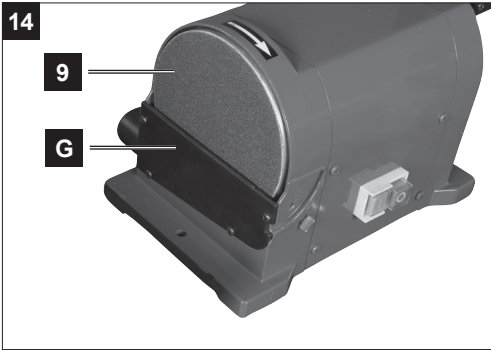
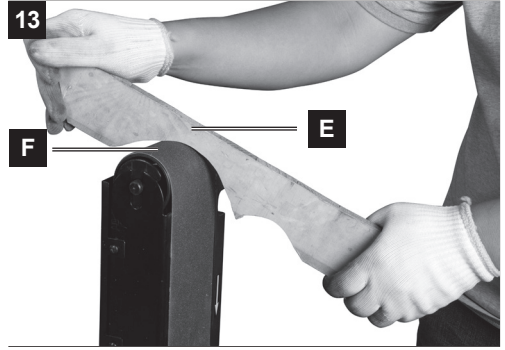
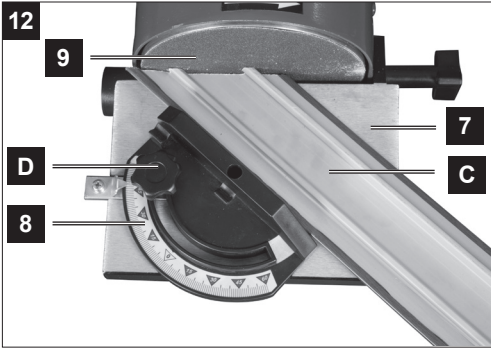

Package contents/part list

- 1 Sanding Belt, 1x
- 2 Belt adjustment knob, 1x
- 3 Belt unlocking lever, 1x
- 4 Tool rest, 1x
- 5 ON- / OFF switch, 1x
- 6 Clamping screw, 1x
- 7 Table, 1x
- 8 Mitre gauge, 1x
- 9 Sanding disc, 1x
- 10 Allen screw with disc, 2x
- 11 Support screw, 1x
- 12.1 Dust outlet for sanding belt, 1x
- 12.2 Dust outlet for sanding disc, 1x
- 13 Washer, 1x
- 14 Allen key, 1x
- 15 Warranty card
- 16 Instruction manual

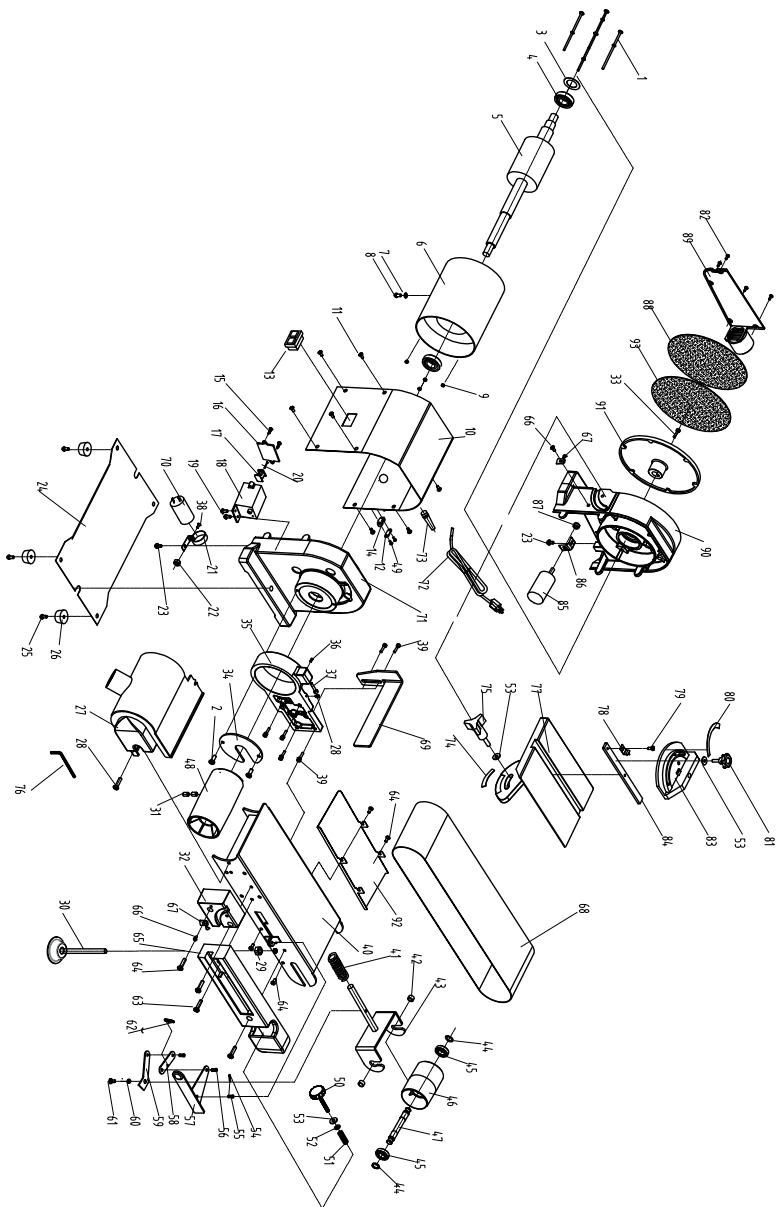

Explanation of Symbols

The use of symbols in this manual is intended to draw your attention to possible risks. The safety symbols and the explanations that accompany them must be perfectly understood. The warnings in themselves do not remove the risks and cannot replace correct actions for preventing accidents.

	<p>Before commissioning, read and observe the operating instructions and safety instructions!</p>
	<p>Wear safety goggles!</p>
	<p>Wear hearing protection!</p>
	<p>If dust builds up, wear respiratory protection!</p>
	<p>Direction of sanding belt.</p>
	<p>Complies with the Australian norms and standards.</p>
	<p>Warranty period.</p>
	<p>Warranty class.</p>

⚠ Attention!	These operating instructions provide places concerning your safety which are marked with this indication.
⚠ Caution!	Failure to follow these instructions may cause light to medium risk of injury.
⚠ Warning!	Failure to follow these instructions may cause danger to life or danger of serious injuries!

Introduction

Congratulations on choosing to buy a FERREX® product.

All products brought to you by FERREX® are manufactured to the highest standards of performance and safety, and as part of our philosophy of customer service and satisfaction, are backed by our comprehensive 5 Year Warranty.

We hope you will enjoy using your purchase for many years to come.

Note:

According to the applicable product liability law the manufacturer of this device is not liable for damages which arise on or in connection with this device in case of:

- improper handling,
- non-compliance with the instructions for use,
- repairs by third party, non-authorised skilled workers,
- installation and replacement of non-original spare parts,
- improper use.

Recommendations:

Read the entire text of the operating instructions prior to the assembly and operation of the device.

These operating instructions are intended to make it easier for you to get familiar with your device and utilise its intended possibilities of use.

The operating instructions contain important notes on how to work safely, properly and economically with your machine and how to avoid dangers, save repair costs, reduce downtime, and increase the reliability and working life of the machine.

In addition to the safety regulations contained herein, you must in any case comply with the applicable regulations of your country with respect to the operation of the machine.

Keep the operating instructions in a clear plastic folder to protect them from dirt and humidity; store them near the machine. The instructions should be read and carefully understood by each operator prior to using the machine. Only persons who have been trained in the use of the machine and are aware of the related dangers and risks should be allowed to use the machine. The local required minimum age must be met.

In addition to the safety notes contained in these operating instructions and any specific regulations in your country, the generally recognised technical rules for the operation of identically constructed machines must be observe-

Layout (Fig. 1)

1. Sanding belt
2. Belt adjustment knob
3. Belt unlocking lever
4. Tool rest
5. ON- / OFF switch
6. Clamping screw
7. Table
8. Mitre gauge
9. Sanding disc (Hook and loop)
10. 2x Allen screw with disc
11. Support screw
- 12.1 Dust outlet for sanding belt
- 12.2 Dust outlet for sanding disc
13. Washer
14. Allen key

Scope of delivery

Belt & Disc sander	1x
Sanding disc - 80 grid	1x
Sanding belt - 80 grid (pre-mounted)	1x
Allen key	1x
Warranty card	1x
Instruction manual	1x

- Open the packaging and take out the equipment with care.
- Remove the packaging material.
- Check that all listed contents are present.
- Inspect the equipment and parts for any damage. Please contact the helpline if anything is missing.

- If possible, keep the packaging until the end of the guarantee period.
- Read the operating instructions fully to familiarise yourself with the tool prior to using it.
- Only use original accessories and spare parts. Spare parts are available by contacting the helpline.
- Specify the part numbers when you contact the helpline.

⚠ ATTENTION!

The device and packaging materials are not toys!

Children must not be allowed to play with plastic bags, film and small parts! There is a risk of swallowing and suffocation!

Intended use

The belt & disc sander 450W is used for sanding all types of wood, depending on the size of the machine. The machine meets the currently valid EU machine directive.

- The manufacturer's safety, operation and maintenance instructions as well as the technical data given in the calibrations and dimensions must be adhered to.
- Relevant accident prevention regulations and other generally recognized safety and technical rules must also be adhered to.
- The machine may only be used, maintained or repaired by

trained persons who are familiar with the machine and have been informed about the dangers. Unauthorized modifications of the machine exclude a liability of the manufacturer for damages resulting from the modifications.

- The machine is intended for use only with original spare parts and original tools from the producer.
- Any other use is considered to be not intended. The manufacturer excludes any liability for resulting damages, the risk is exclusively borne by the user.

Please note that our equipment has not been designed for use in commercial, trade or industrial applications. Our warranty will be voided if the equipment is used in commercial, trade or industrial businesses or for equivalent purposes.

Safety regulations

⚠ WARNING ! Read all safety warnings, instructions, illustrations and specifications provided with this power tool. Failure to follow all instructions listed below may result in electric shock, fire and/or serious injury.

Save all warnings and instructions for future reference.

The term “power tool” in the warnings refers to your mains-operated (corded) power tool or battery-operated (cordless) power tool.

1) Work area safety

- Keep work area clean and well lit. Cluttered or dark areas invite accidents.
- Do not operate power tools in explosive atmospheres, such as in the presence of flammable liquids, gases or dust. Power tools create sparks which may ignite the dust or fumes.
- Keep children and bystanders away while operating a power tool. Distractions can cause you to lose control.

2) Electrical safety

- Power tool plugs must match the outlet. Never modify the plug in any way. Do not use any adapter plugs with earthed (grounded) power tools. Unmodified plugs and matching outlets will reduce risk of elec-

tric shock.

- Avoid body contact with earthed or grounded surfaces, such as pipes, radiators, ranges and refrigerators. There is an increased risk of electric shock if your body is earthed or grounded.
- Do not expose power tools to rain or wet conditions. Water entering a power tool will increase the risk of electric shock.
- Do not abuse the cord. Never use the cord for carrying, pulling or unplugging the power tool. Keep cord away from heat, oil, sharp edges or moving parts. Damaged or entangled cords increase the risk of electric shock.
- When operating a power tool outdoors, use an extension cord suitable for outdoor use. Use of a cord suitable for outdoor use reduces the risk of electric shock.
- Recommendation that the tool always be supplied via a residual current device having a rated residual current of 30 mA or less.

3) Personal safety

- Stay alert, watch what you are doing and use common sense when operating a power tool. Do not use a power tool while you are tired or under the influence of drugs, alcohol or medication. A moment of inattention while operating power tools may result in serious personal injury.
- Use personal protective equipment. Always wear eye protection. Protective equipment such as a dust mask, non-skid safety shoes, hard hat or hearing protection used for appropriate conditions will reduce personal injuries.
- Prevent unintentional starting. Ensure the switch is in the off-position before connecting to power source and/or battery pack, picking up or carrying the tool. Carrying power tools with your finger on the switch or energising power tools that have the switch on invites accidents.
- Remove any adjusting key or wrench before turning the power tool on. A wrench or a key left attached to a rotating part of the power tool may result in personal injury.

- Do not overreach. Keep proper footing and balance at all times. This enables better control of the power tool in unexpected situations.
- Dress properly. Do not wear loose clothing or jewellery. Keep your hair and clothing away from moving parts. Loose clothes, jewellery or long hair can be caught in moving parts.
- If devices are provided for the connection of dust extraction and collection facilities, ensure these are connected and properly used. Use of dust collection can reduce dust-related hazards.
- Do not let familiarity gained from frequent use of power tools allow you to become complacent and ignore power tool safety principles. A careless action can cause severe injury within a fraction of a second.

4) Power tool use and care

- Do not force the power tool. Use the correct power tool for your application. The correct power tool will do the job better and safer at the rate for which it was designed.
- Do not use the power tool if the switch does not turn it on and off. Any power tool that cannot be controlled with the switch is dangerous and must be repaired.
- Disconnect the plug from the power source and/or remove the battery pack, if detachable, from the power tool before making any adjustments, changing parts of insert tools, or storing power tools. Such preventive safety measures reduce the risk of starting the power tool accidentally.
- Store idle power tools out of the reach of children and do not allow persons unfamiliar with the power tool or these instructions to operate the power tool. Power tools are dangerous in the hands of untrained users.
- Maintain power tools and insert tools. Check for misalignment or binding of moving parts, breakage of parts and any other condition that may affect the power tool's operation. If damaged, have the power tool repaired before use. Many accidents are caused by poorly maintained power tools.

- Keep cutting tools sharp and clean. Properly maintained cutting tools with sharp cutting edges are less likely to bind and are easier to control.
- Use the power tool, accessories and tool bits etc. in accordance with these instructions, taking into account the working conditions and the work to be performed. Use of the power tool for operations different from those intended could result in a hazardous situation.
- Keep handles and grasping surfaces dry, clean and free from oil and grease. Slippery handles and grasping surfaces do not allow for safe handling and control of the tool in unexpected situations.

5) Service

- Have your power tool serviced by a qualified repair person using only identical replacement parts. This will ensure that the safety of the power tool is maintained.
 - **Warning!** This electric tool generates an electromagnetic field during operation. This field can impair active or passive medical implants under certain conditions. In order to prevent the risk of serious or deadly injuries, we recommend that persons with medical implants consult with their physician and the manufacturer of the medical implant prior to operating the electric tool.
 - Additional safety rules for the belt and disc sanding machine
 - **Warning:** Do not use your machine until it is completely assembled and installed according to the instructions.
 - If you are not familiar with the operation of the sanding machine, ask the head of the department, your teacher, or any other qualified person.
 - **Attention:** This machine has only been designed for sanding wood or similar materials. The sanding of other materials can cause fire, injuries, or damage the product.
 - Always wear safety goggles.
 - This machine may only be operated indoors.
 - **Important:** Mount and use the machine on a horizontal surface. A non-horizontal surface can damage the motor.
-

- If the machine tends to tilt or walk (especially when sanding long and heavy panels), it must be fastened to a solid surface of sufficient carrying force.
- Make sure the sanding belt runs in the correct direction – see arrows at the back of the belt.
- Make sure the sanding belt is running correctly so that it cannot come off the drive pulleys.
- Make sure the sanding belt is not twisted or loose.
- Firmly hold the workpiece when sanding.
- Always use the fence when using the sanding machine in horizontal position.
- Always hold the workpiece firmly to the table when using the sanding disc.
- Always hold the workpiece to the side of the sanding disc running downwards, in order to maintain the workpiece pressed to the table. By using the upward-running side of the sanding disc, the workpiece could be ejected and cause injury to persons.
- Always keep a minimum distance of about 1.5 mm or less between the table or fence and the sanding belt or disc.
- Do not wear gloves. Do not hold the workpiece with a cloth during sanding.
- Use sanding belt or disc of the correct grit corresponding with the wood.
- Never sand workpieces too small to be held safely.
- Avoid awkward hand positions where a sudden slip could cause your hand to touch the sanding belt or disc.
- When sanding a large piece of material, provide an additional support at table height.
- Never sand an unsupported workpiece. Secure the workpiece with the table or the fence. Exceptions are the sanding of curved workpieces on the outside of the sanding disc.
- Always clear the table, fence or sanding belt of scraps or other objects, before turning the machine on.
- Do not perform any layout assembly or set-up work on the table while the sanding machine is in operation.

- Switch the machine off and pull the power plug from the socket when fitting or removing accessories.
- Never leave the working area of the sanding machine while the tool is running, or as long as it has not come to an absolute standstill.

Residual risks

The machine has been built using modern technology and in accordance with recognized safety rules.

Some hazards, however, may still remain.

- The grinding wheel poses a danger of injury to fingers and hands by improper feeding or placement of tools.
- Danger of injury from thrown tools due to improper holding or feeding.
- The use of incorrect or damaged mains cables can lead to electrical injuries.
- Although having regarded all considerable rules there may still remain not obvious remaining hazards.
- Minimize remaining hazards by following the instructions in "Safety regulations", "Use only as authorized" and in the entire operating manual.

Assembly

Do not connect to power supply until assembly is complete. Failure to comply could result in accidental starting and possible serious injury.

Mounting of the sanding disc (Fig. 2)

Attach the sanding disc (9) in the middle of the hook and loop sanding pad at the machine.

Mounting of support screw (Fig. 3)

Screw the support screw (11) into the housing of the sanding belt (1) by hand and secure the nut of the support screw (11) with an open-end key (size 16 mm / not scope of delivery).

This machine has two options for mounting the table (7).

Option 1:

1. Put the table (7) into the slot near by the sanding disc (9) and fix it with the clamping screw (6) and washer (13). (Fig. 4)

2. Attach the tool rest (4) to the housing of the sanding belt (1) and secure it with the allen screw with disc (10) and the allen key (14). (Fig. 5)
3. The maximum distance between sanding belt (1) and tool rest (4) must be 1.6mm.

Option 2:

1. Remove the tool rest (4) from the sanding belt housing. (Fig. 5)
2. Put the table (7) into the slot at the sanding belt housing and secure it with the clamping screw (6) and washer (13). (Fig. 6)

Miter gauge mounting (Fig. 7)

Push the miter gauge (8) into the slot of the table (7).

Mounting machine to a work bench (Fig. 8)

It is necessary to secure the machine to a workbench or other stable surface before the first use. When mounting the machine to a workbench, holes should be drilled through the supporting surface of the workbench.

1. Mark holes on workbench where the machine is to be mounted using the holes (A) in the base as a template for hole pattern.
2. Drill holes through workbench.
3. Place the machine on the workbench aligning holes in the base with holes drilled in the workbench.
4. Insert bolts (not included) and tighten securely with lock washers and allen nuts (not included).

Note:

All bolts should be inserted from the top. Install the lock washers and allen nuts from the underside of the workbench.

Dust collection (Fig. 1)

Make sure that always a dust collector is connected to the dust outlet (12.1 / 12.2) at the desired working position.

Operation

⚠ WARNING!: Before performing any adjustment, make sure the machine is unplugged from the power supply and the machine is switched OFF. Failure to heed this warning could result in serious personal injury.

Adjusting the sanding belt tracking (Fig. 1)

- Plug in the machine.

To check sanding belt tracking:

- Turn the ON-/ OFF switch (5) ON and then immediately turn it OFF. If the sanding belt (1) tends to slide off the idler drum or drive drum, the sanding belt (1) is not tracking properly.

To adjust sanding belt tracking:

1. Turn the belt adjustment knob (2) clockwise to adjust the sanding belt (1) to the left direction.
2. Turn the belt adjustment knob (2) anticlockwise to adjust the sanding belt (1) to the right direction.
3. Turn the ON-/OFF switch (5) ON and then immediately OFF again, noting belt movement. Readjust the belt adjustment knob (2) if necessary.

Angle adjustment of the sanding belt housing (Fig. 9/10)

Your belt & disc sander can sand both vertically and horizontally. Depending on the workpiece, the work support can be used with either the horizontal or vertical sanding operation.

1. Loosen the screw (B) with the allen key (14).
2. Adjust the sanding belt housing in the desired position.
3. Tighten the screw (B) again.

Bevel sanding (Fig. 1/6)

The table (7) can be tilted from 0° to 45° for bevel sanding. To tilt the table (7):

1. The table (7) must be mounted at the sanding disc side or sanding belt side.
2. Loosen the clamping screw (6) by turning it anticlockwise.
3. Set the table (7) to desired angle.
4. Tighten the clamping screw (6) by turning it clockwise.

Switching ON/OFF (Fig. 1)

- Press the green button to switch the machine ON.
- Press the red button to switch the machine OFF.

⚠ WARNING!:

Do not touch the sanding disc (9) or the sanding belt (1) while switching ON/OFF. Risk of injury!

Surface sanding with the sanding belt (Fig. 11)

1. Hold the workpiece (C) firmly, keeping fingers away from the sanding belt.
2. Keep the end pressed firmly against the tool rest (4) moving work evenly across the sanding belt.

Sanding with the sanding disc (Fig. 12)

1. Hold the workpiece (C) firmly, keeping fingers away from the sanding disc.
2. Only work with the sanding disc (9) in combination with the table (7).

Note:

Use extra caution when sanding very thin pieces and when sanding extra long pieces. Apply only enough pressure to allow the sanding belt to remove the material.

Using the mitre gauge (Fig. 12)

Use of the mitre gauge (8) is recommended for sanding small end surfaces. The mitre gauge (8) can be adjusted by loosening the clamping screw (D). Using the mitre gauge (8) is only allowed in combination with the table (7).

Note:

Always move the workpiece across the sanding disc (9) or sanding belt from the left side towards the right side.

Sanding curved pieces (Fig. 13)

WARNING:

Never attempt to sand the end pieces of a workpiece on the idler drum (upper part of the belt housing). Applying the end of the workpiece on the idler drum could cause the workpiece to fly up. Failure to heed this warning could result in serious personal injury.

Sanding inside curves on sanding belt:

Always sand inside curves on the idler drum as shown in Figure 13.

- Hold the workpiece (E) firmly, keeping fingers away from the sanding belt.
- Keep the curve pressed firmly against the idler drum (F) moving work evenly across the sanding belt.

Note:

Use extra caution when sanding very thin pieces and apply only enough pressure to allow the sanding belt to remove the material.

WARNING:

Applying the workpiece to the right side of the sanding disc **could cause the workpiece kickback.** Failure to heed this warning could result in serious personal injury.

After Use

⚠ WARNING! Prior to any adjustment, maintenance or service work switch off the machine and disconnect the mains power plug!

Cleaning

- Keep all safety devices, air vents and the motor housing free of dirt and dust as far as possible. Wipe the machine with a clean cloth or blow it with compressed air at low pressure.
- We recommend that you clean the machine immediately each time you have finished using it.
- Clean the machine regularly with a moist cloth and some soft soap. Do not use cleaning agents or solvents; these could attack the plastic parts of the machine. Ensure that no water can seep into the machine.

Maintenance

After using your belt/disc sander, clean it completely and lubricate all sliding and moving parts. Apply a light coat of automotive type paste wax to the worktable to help keep the surfaces clean.

Motor housing

Frequently blow out any dust that may accumulate inside the motor housing.

Changing the sanding disc (Fig. 14)

1. Remove the disc guard (G) by loosening the screws with a screwdriver (not scope of delivery).
2. Remove the worn sanding disc (9).
3. Align perimeter of sanding disc (9) with plate and press firmly into position.
4. Mount the disc guard (G) again.

Installing/Replacing sanding belt (Fig. 15/16/17)

1. Loosen the two screws at the side of the sanding belt housing with a screwdriver (not included) and remove the belt cover (H).
2. Remove the support screw (11).
3. Loosen the two screws at the front and the side of the drum cover (I) with a screwdriver (not included) and remove the drum cover (I).
4. Open the belt unlocking lever (3).
5. Pull the sanding belt (1) from the belt housing.
6. Insert a new sanding belt (1) and mount all disassembled parts again.

Technical data

Dimensions L x W x H	560 x 270 x 530 mm
Sanding disc \varnothing	150 mm
Idle speed n_0 / Disc speed n_0	2980 rpm
Belt dimensions	100 x 914 mm
Belt speed	550 m/min
Belt tilt	0° - 90°
Table size	195 x 136 mm
Table tilt	0° - 45°
Weight	13.5 kg
Motor	230-240 V / 50 Hz
Input power S1	S1 450 W
Protection class	class I

The workpiece must have a minimum height of 3 mm and a minimum width of 45 mm. Make sure that the workpiece is always secured with the clamping device.

Noise

Sound values were measured in accordance with EN 62841-1.

Sound pressure level L_{pA} (no load / load)	84.2 dB(A) / 85.9 dB(A)
Uncertainty K_{pA}	3 dB
Sound power level L_{WA} (no load / load)	93.4 dB(A) / 95.5 dB(A)
Uncertainty K_{pA}	3 dB

Wear ear protection.

The impact of noise can cause damage to hearing.

Limit the noise to a minimum!

- Only use appliances which are in perfect working order.
- Service and clean the appliance regularly.
- Adapt your working style to suit the appliance.
- Do not overload the appliance.

- Have the appliance serviced whenever necessary.
- Switch the appliance off when it is not in use.
- Wear protective gloves.

Storage and transport

Store the machine and accessories out of children's reach in a dark and dry place at above freezing temperature. The ideal storage temperature is between 5 and 30 °C. Store the machine in its original packaging.

⚠ ATTENTION!

The appliance must unconditionally be secured against falling or turning down during transport.

When transporting the machine, only use the transport devices. Never use the protective devices for handling or transport.

Electrical connection

The electrical motor installed is connected and ready for operation. The connection complies with the applicable Australian standards.

The customer's mains connection as well as the extension cable used must also comply with these regulations.

Damaged electrical connection cable

The insulation on electrical connection cables is often damaged.

This may have the following causes:

- Passage points, where connection cables are passed through windows or doors.
- Kinks where the connection cable has been improperly fastened or routed.
- Places where the connection cables have been cut due to being driven over.
- Insulation damage due to being ripped out of the wall outlet.
- Cracks due to the insulation ageing.

Such damaged electrical connection cables must not be used and are life-threatening due to the insulation damage. Check the electrical connection cables for damage regularly. Make sure that the power is switched off before inspecting the cable. Electrical connection cables must comply with the applicable Australian standards and must be correctly marked. Only use connection cables with the marking "H05VV-F". Replacement cables can only be fitted by an approved and certified electrician. If you are in any doubt please contact the help line at the foot of this page.

Use a socket-outlet with earthing contact:

The device may only be operated from an outlet with the properly installed earthing contact.

AC motor

- The mains voltage must be 230 - 240 V~
- Extension cables up to 25 m long must have a cross-section of 1.5 mm².

Connections and repairs of electrical machines may only be carried out by an electrician.

Please provide the following information in the event of any enquiries:

- Type of current for the motor
- Machine data - type plate
- Machine data - type plate

We recommend always supplying the tool via a residual current circuit breaker with a rated residual current of 30 mA or less.

Disposal and recycling

The equipment is supplied in packaging to prevent it from being damaged in transit. The raw materials in this packaging can be reused or recycled. The equipment and its accessories are made of various types of material, such as metal and plastic. Never place defective equipment in your household refuse. The equipment should be taken to a suitable collection center for proper disposal. If you do not know the whereabouts of such a collection point, you should ask in your local council offices.

Troubleshooting

The table below contains a list of fault symptoms and explains what you can do to remedy the problem if your equipment fails to work properly. If the problem still persists after working through the list, please contact your nearest service workshop.

⚠ IMPORTANT!

Hint in case of sending the equipment to a service centre:

Fault	Possible cause	Remedy
Motor does not work	Motor, cable or plug defective, fuses burnt	Arrange for inspection of the machine by a specialist. Never repair the motor yourself. Danger! Check fuses and replace as necessary
The motor starts up slowly and does not reach operating speed.	Voltage too low, coils damaged, capacitor burnt	Contact the utility provider to check the voltage. Arrange for inspection of the motor by a specialist. Arrange for replacement of the capacitor by a specialist
Motor makes excessive noise	Coils damaged, motor defective	Arrange for inspection of the motor by a specialist
The motor does not reach its full power.	Circuits in the network are overloaded (lamps, other motors, etc.)	Do not use any other machine or motors on the same circuit
Motor overheats easily.	Overloading of the motor, insufficient cooling of the motor	Avoid overloading the motor while sanding, remove dust from the motor in order to ensure optimal cooling of the motor



FERREX®

Belt & Disc Sander 450W

Warranty Details

REGISTER YOUR PURCHASE AT www.aldi.com.au/en/about-aldi/product-registration/
TO KEEP UP-TO-DATE WITH IMPORTANT PRODUCT INFORMATION

The product is guaranteed to be free from defects in workmanship and parts for a period of 60 months from the date of purchase. Defects that occur within this warranty period, under normal use and care, will be repaired, replaced or refunded at our discretion. The benefits conferred by this warranty are in addition to all rights and remedies in respect of the product that the consumer has under the Competition and Consumer Act 2010 and similar state and territory laws.

Our goods come with guarantees that cannot be excluded under the Australian Consumer Law. You are entitled to a replacement or refund for a major failure and for compensation for any other reasonably foreseeable loss or damage. You are also entitled to have the goods repaired or replaced if the goods fail to be of acceptable quality and the failure does not amount to a major failure.

AFTER SALES SUPPORT

 1300 855 831

 support@schepach.com.au

AU Hotline Costs: Local rate for landline calls*

*Charges may vary dependent upon network operator or mobile network provider.

A black rounded square containing the number '5' in a large, bold, white font, with the words 'YEAR' and 'WARRANTY' in smaller white capital letters below it.

5
YEAR
WARRANTY



FERREX®

Belt & Disc Sander 450W

Repair and Refurbished Goods or Parts Notice

REGISTER YOUR PURCHASE AT www.aldi.com.au/en/about-aldi/product-registration/
TO KEEP UP-TO-DATE WITH IMPORTANT PRODUCT INFORMATION

Unfortunately, from time to time, faulty products are manufactured which need to be returned to the Supplier for repair.

Please be aware that if your product is capable of retaining user-generated data (such as files stored on a computer hard drive, telephone numbers stored on a mobile telephone, songs stored on a portable media player, games saved on a games console or files stored on a USB memory stick) during the process of repair, some or all of your stored data may be lost.

We recommend you save this data elsewhere prior to sending the product for repair.

You should also be aware that rather than repairing goods, we may replace them with refurbished goods of the same type or use refurbished parts in the repair process.

Please be assured though, refurbished parts or replacements are only used where they meet ALDI's stringent quality specifications.

If at any time you feel your repair is being handled unsatisfactorily, you may escalate your complaint. Please telephone us on "1300 855 831" or write to us at:

RossMac Pty. Ltd.

P.O. Box 261, Essendon North, Victoria, 3041

Telephone: 1300 855 831 (Monday - Friday 8:30am-6:00pm)

Email: support@schepach.com.au

AFTER SALES SUPPORT

 1300 855 831

 support@schepach.com.au

AU Hotline Costs: Local rate for landline calls*

*Charges may vary dependent upon network operator or mobile network provider.